

LOUISIANA
GULF COAST INDEX

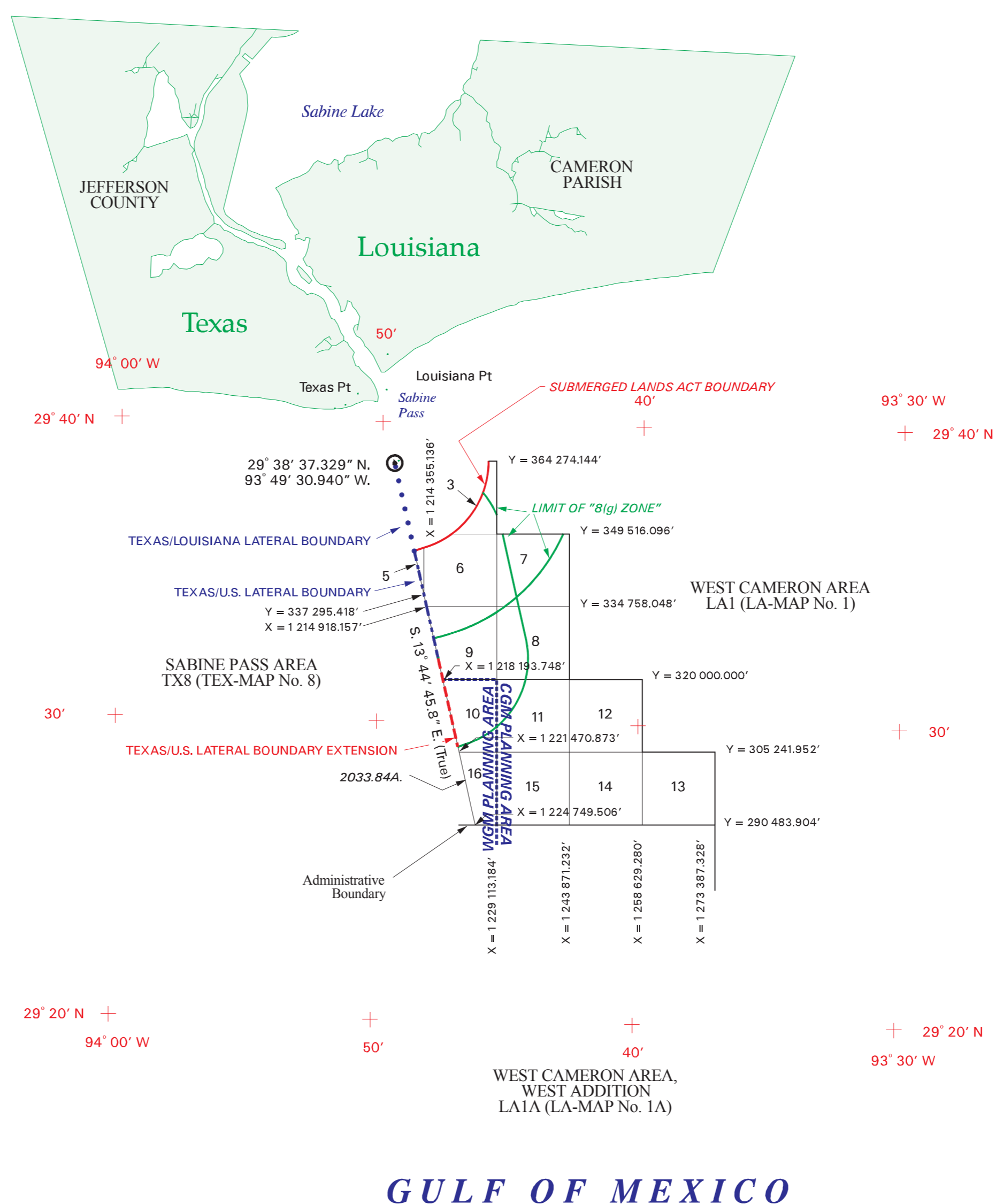
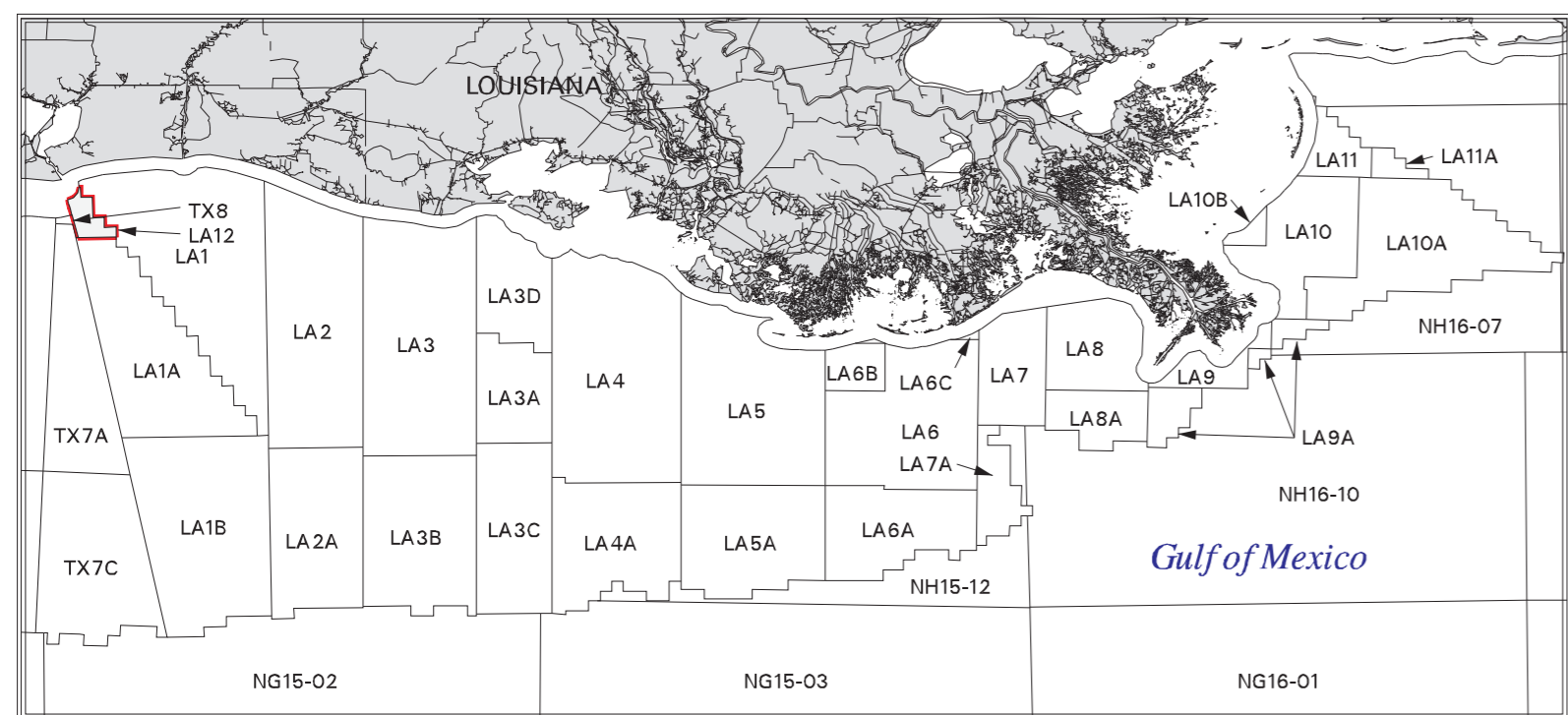

GULF OF MEXICO

All Louisiana blocks are based on the Louisiana (Lambert) Plane Coordinate System, South Zone, with X origin = 2,000,000' at 91° 20' W and Y origin = 0.00' at 28° 40' N.

Regular blocks are 14,758,048 feet on a side and contain 5,000 acres. Areas and dimensions of the irregular blocks are as indicated.

The Submerged Lands Act Boundary and the Limit of "8(g) Zone" depicted hereon reflect the official Federal position for Submerged Lands Act and OCS Lands Act purposes. The areas of the fractional blocks abutting these lines have been determined and are as depicted on the Supplemental Official OCS Block Diagrams (SOBDs). Consult the SOBDs for official descriptions and approval dates.

Onshore planimetric base compilation is from U.S.G.S. 1:100,000 Digital Line Graph (DLG) files.

The west boundary of this area as shown hereon has been adopted administratively as the limiting boundary of the leasing blocks; it is not to be construed as being an extension of the boundary between the States of Texas and Louisiana.

This revised map supersedes leasing map SABINE PASS AREA, LA-MAP No. 12, approved 07-MAR-1977, and LA12 revised 30-MAY-1997, revised 01-NOV-2000, and revised 28-FEB-2007.

Copies of these diagrams and other information may be obtained at the appropriate BOEMRE OCS Region or from <http://www.boemre.gov/offshore/mapping/index.htm>

Subdivision of Blocks on the Outer Continental Shelf

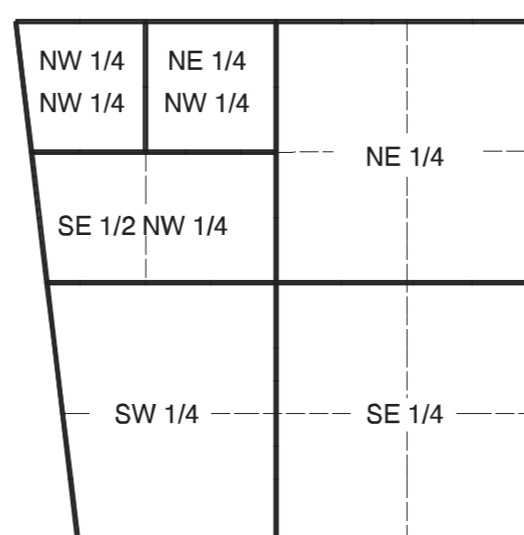

Typical method of subdivision of irregular blocks based on the plan for midpoint subdivision of a regular block with fractional measurements and areas along the west boundary.

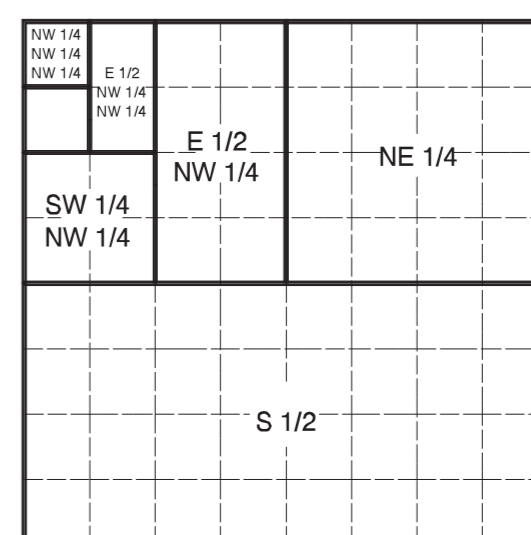
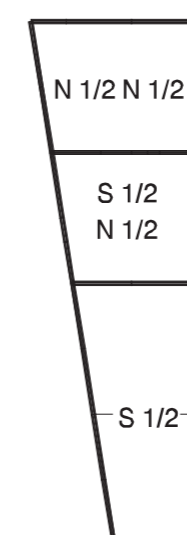

Typical method of subdivision of the regular blocks, each subdivision being an aliquot part of the total, based on midpoint subdivision throughout.

UNITED STATES DEPARTMENT OF THE INTERIOR
BUREAU OF OCEAN ENERGY MANAGEMENT, REGULATION AND ENFORCEMENT
OUTER CONTINENTAL SHELF LEASING MAP
LOUISIANA
NORTH AMERICAN DATUM OF 1927

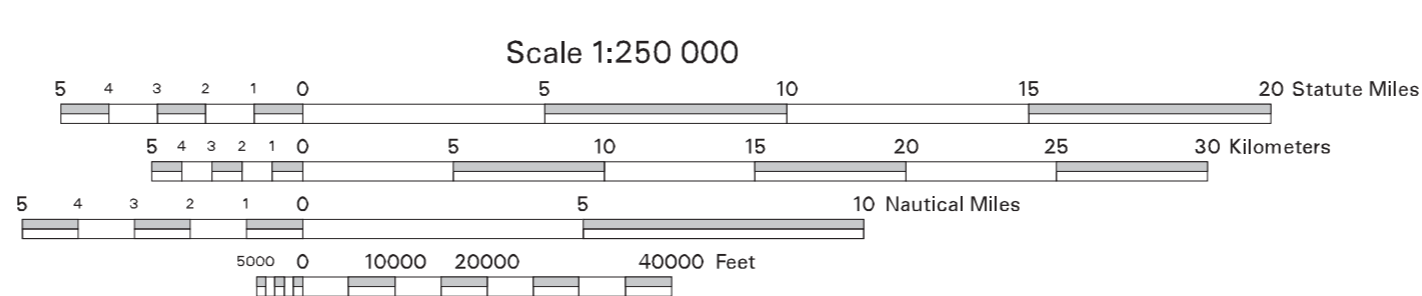

This diagram is prepared in accordance with 30 CFR 256.8

For the Director

Doyle S. Vandegeest
Chief, Mapping and Boundary Branch, Leasing Division
Herndon, Virginia Date 01-JULY-2011

Revised