

LOUISIANA  
 GULF COAST INDEX

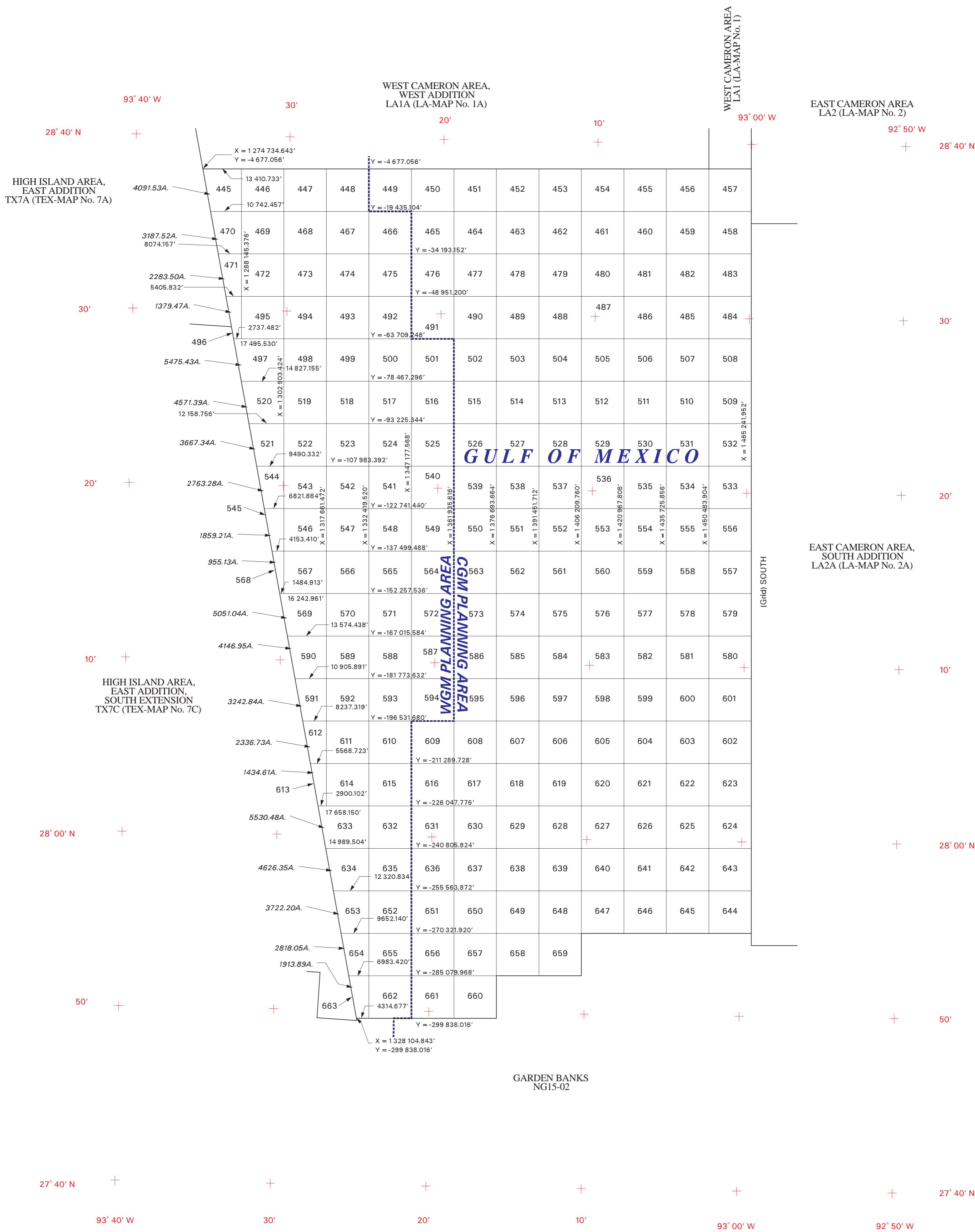
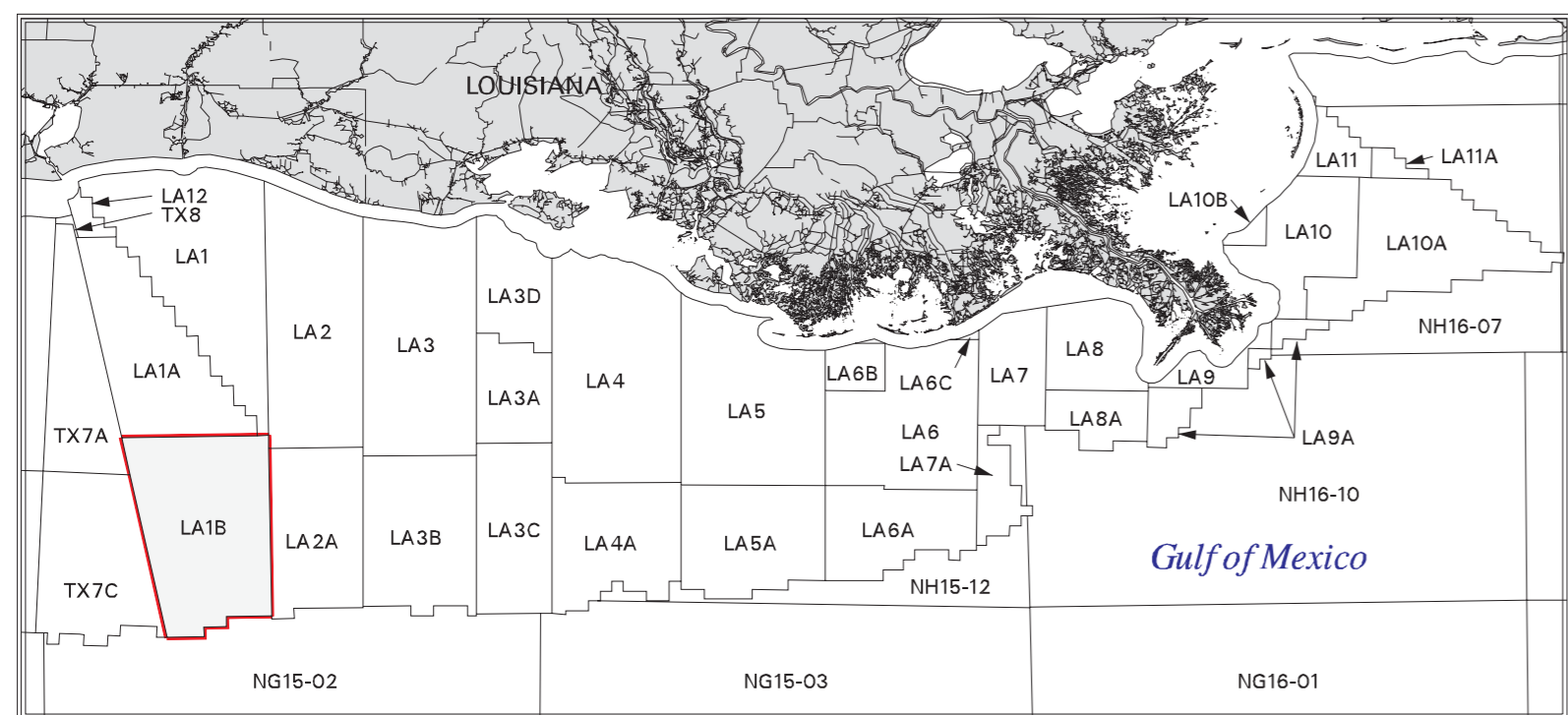

All blocks are based on the Louisiana (Lambert) Plane Coordinate System, South Zone, with X origin = 2,000,000' at 91° 20' W and Y origin = 0.00' at 28° 40' N.

Regular blocks are 14,758.048 feet on a side and contain 5,000 acres. Areas and dimensions of the irregular blocks are as indicated.

The west boundary of this area as shown hereon has been adopted administratively as the limiting boundary of the leasing blocks; it is not to be construed as being an extension of the boundary between the States of Texas and Louisiana.

This revised map supersedes leasing map WEST CAMERON AREA, SOUTH ADDITION, LA-MAP No. 1B, approved 08-SEP-1959, revised 19-OCT-1981, revised 01-JUN-1988, and LA1B revised 30-MAY-1997, and revised 01-NOV-2000.

Copies of these diagrams and other information may be obtained at the appropriate MMS OCS Region, or from www.mms.gov/ld/maps.htm.

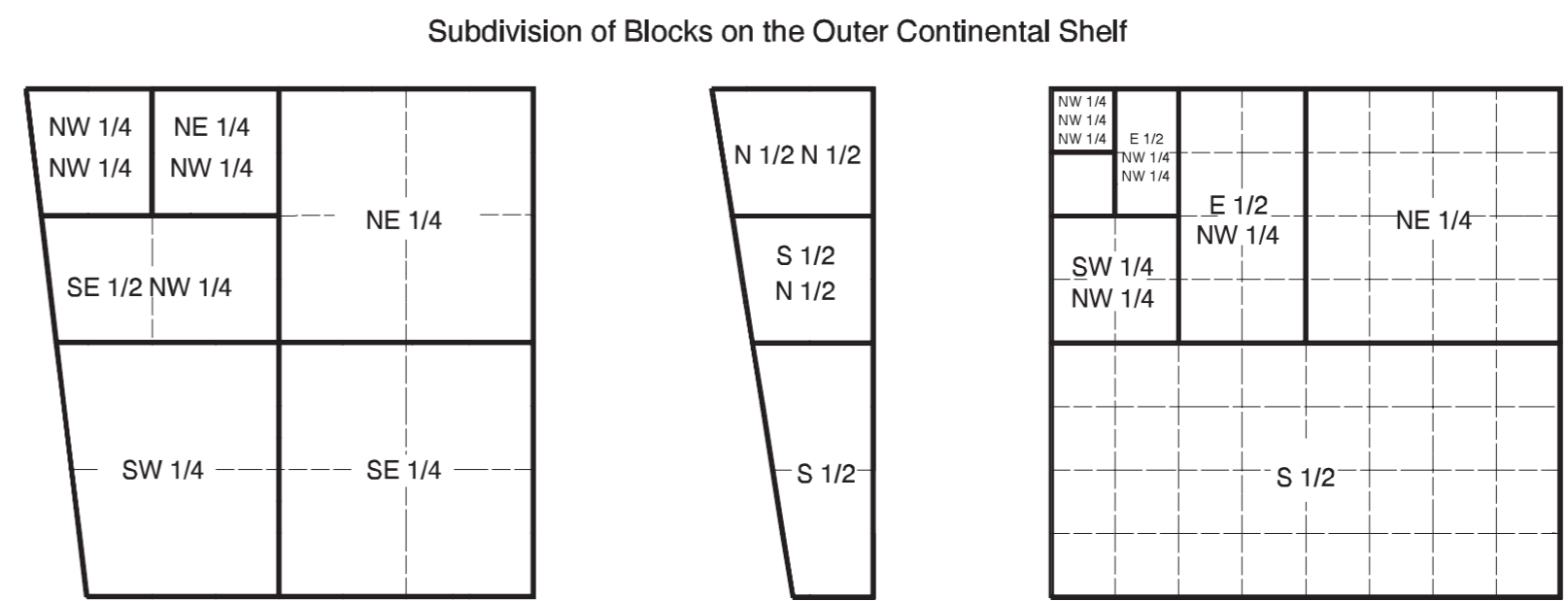

Typical method of subdivision of irregular blocks based on the plan for midpoint subdivision of a regular blocks, with fractional measurements and areas along the west boundary.

Typical method of subdivision of the regular blocks, each subdivision being an aliquot part of the total, based on midpoint subdivision throughout.

UNITED STATES DEPARTMENT OF THE INTERIOR  
 MINERALS MANAGEMENT SERVICE  
 OUTER CONTINENTAL SHELF LEASING MAP  
 LOUISIANA

NORTH AMERICAN DATUM OF 1927

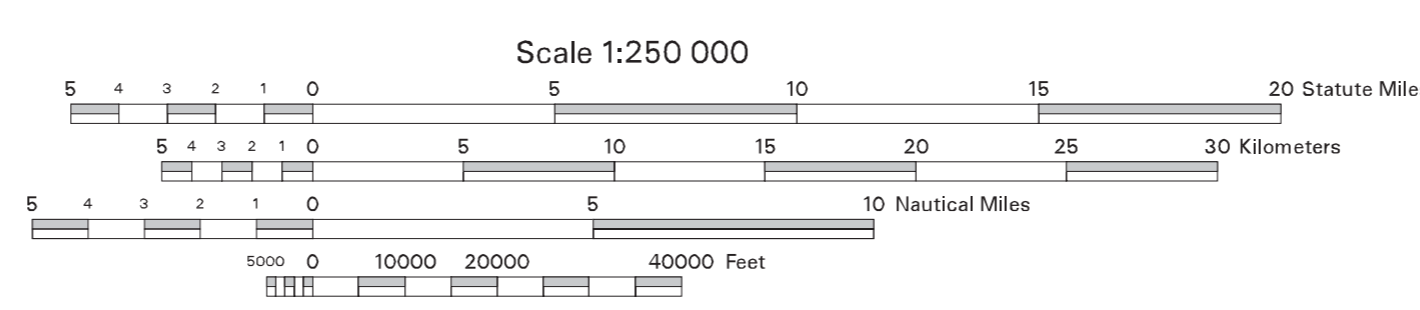

This diagram is prepared in accordance with 30 CFR 256.8

For the Director  
*Stephen S. Foy*  
 Chief, Mapping and Boundary Branch, Leasing Division  
 Herndon, Virginia Date 28-FEB-2007

Revised