

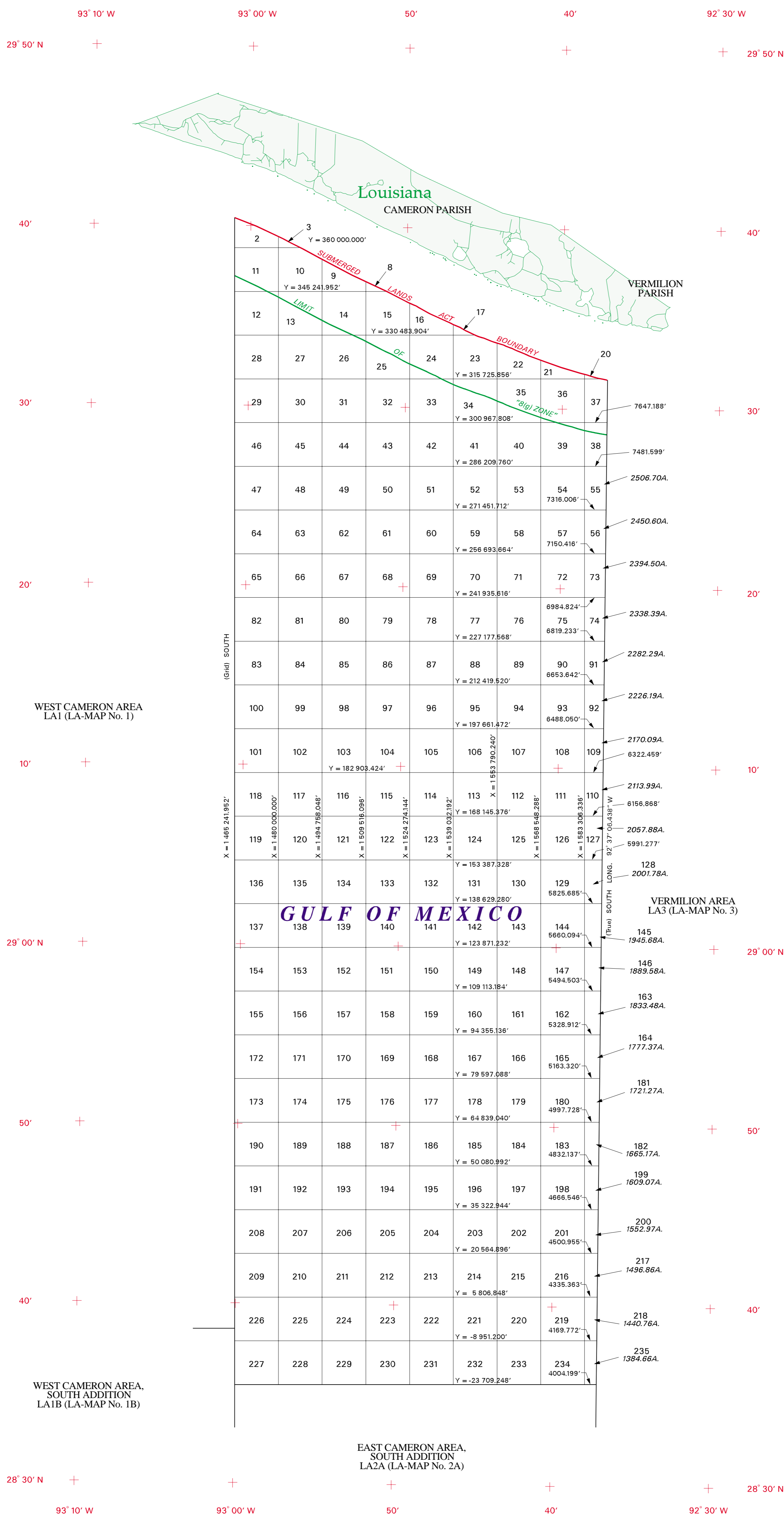

**LOUISIANA  
GULF COAST INDEX**

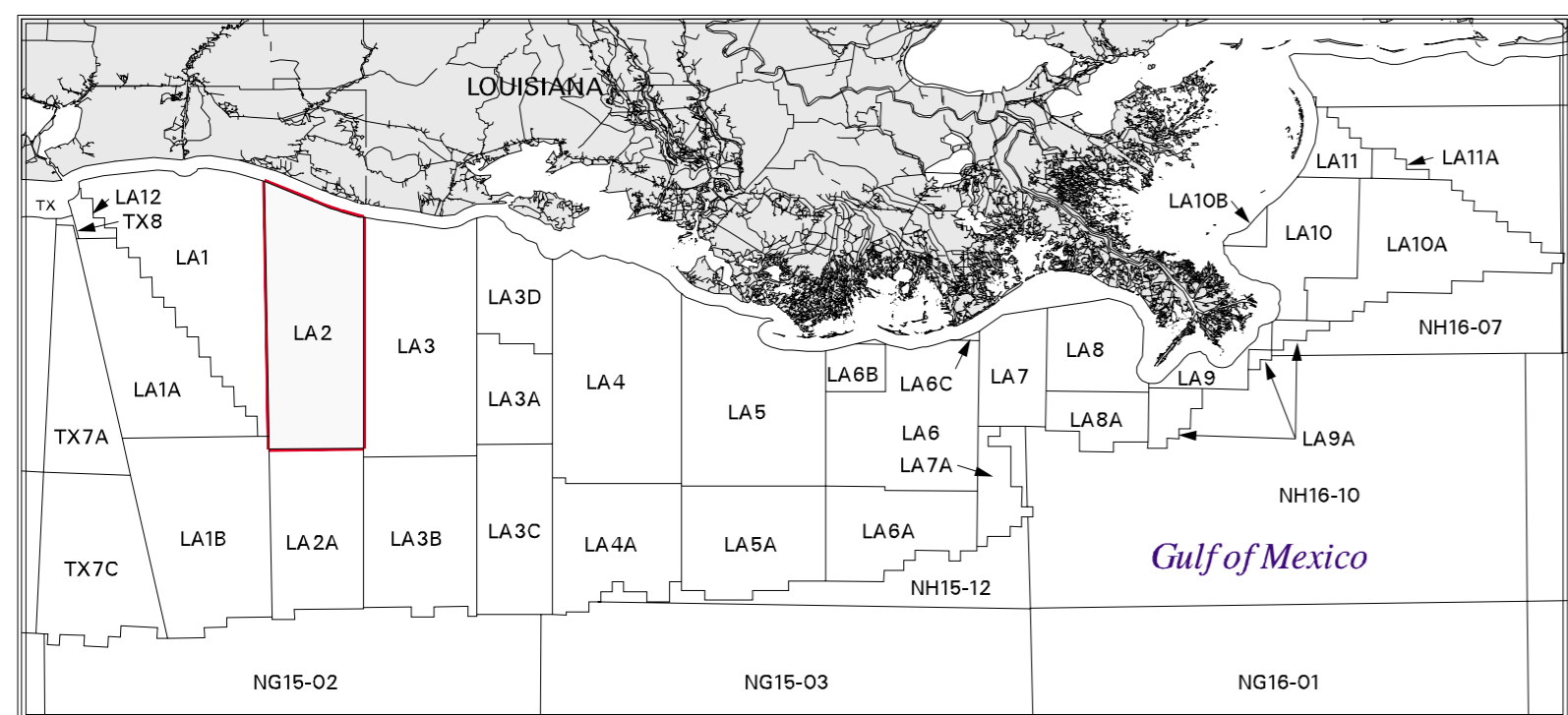

All blocks are based on the Louisiana (Lambert) Plane Coordinate System, South Zone, with X origin = 2,000,000' at 91° 20' W and Y origin = 0.000' at 28° 40' N.

Onshore planimetric base compilation is from USCS 1:100 000 Digital Line Graph (DLG) files.

Regular blocks are 14,758,048 feet on a side and contain 5,000 acres. The areas and dimensions of the irregular blocks are as indicated.

The Submerged Lands Act Boundary and Limit of "8(g) Zone" lines depicted hereon reflect the official federal position for Submerged Lands Act and OCS Lands Act purposes. The areas of the fractional blocks abutting these lines have been determined and are as depicted on the Supplemental Official OCS Block Diagrams (SOBD's). Consult the SOBD's for official descriptions and approval dates.

This revised map supersedes leasing map EAST CAMERON AREA, LA-MAP No. 2, approved 08-JUN-1954, revised 01-AUG-1973, revised 01-JUN-1988, and LA2 revised 01-SEP-1999.

Copies of these diagrams and other information may be obtained at the appropriate MMS OCS Region.

**Subdivision of Blocks on the Outer Continental Shelf**

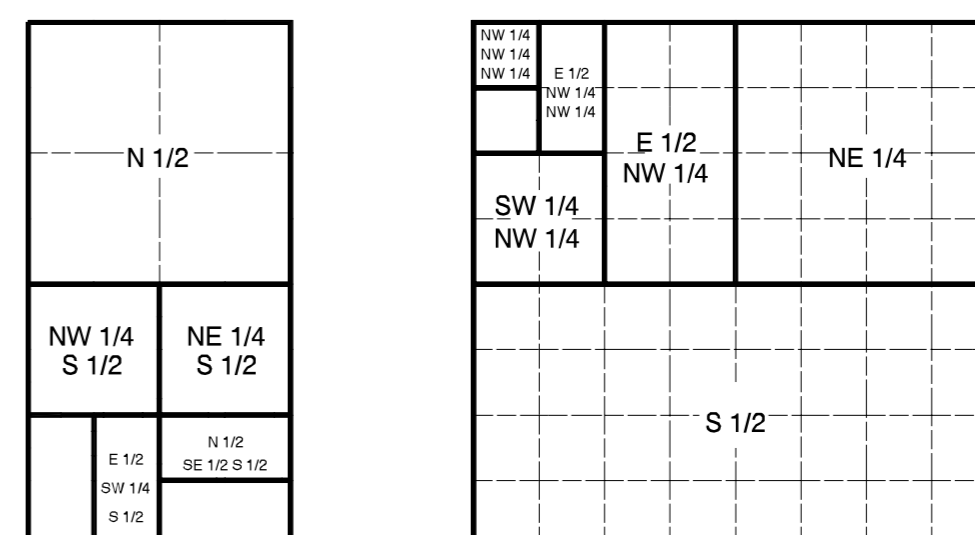

Typical method of subdivision of the irregular blocks along the east boundary, each subdivision being an aliquot part of the total, based on midpoint subdivision throughout.

Typical method of subdivision of the regular blocks, each subdivision being an aliquot part of the total, based on midpoint subdivision throughout.

UNITED STATES DEPARTMENT OF THE INTERIOR  
MINERALS MANAGEMENT SERVICE

**OUTER CONTINENTAL SHELF LEASING MAP  
LOUISIANA**

NORTH AMERICAN DATUM OF 1927

Scale 1:250 000

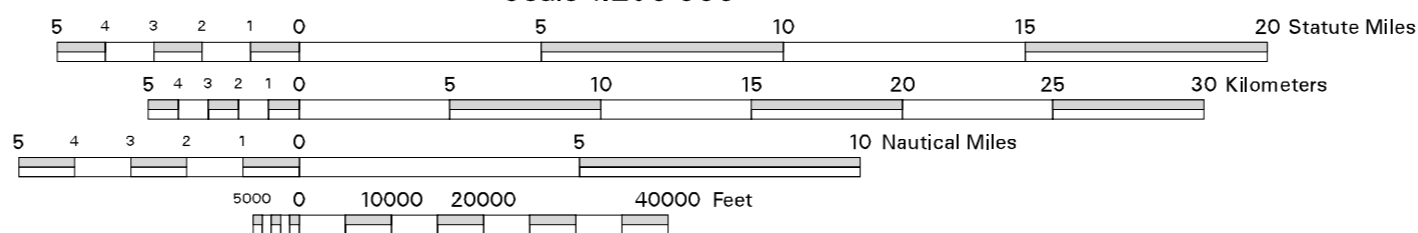

This diagram is prepared in accordance with 30 CFR 256.8

For the Director

*Selma E. Hummel*

Chief, Leasing Division, Mapping and Boundary Branch  
Denver, Colorado Date 01-NOV-2000

Revised