

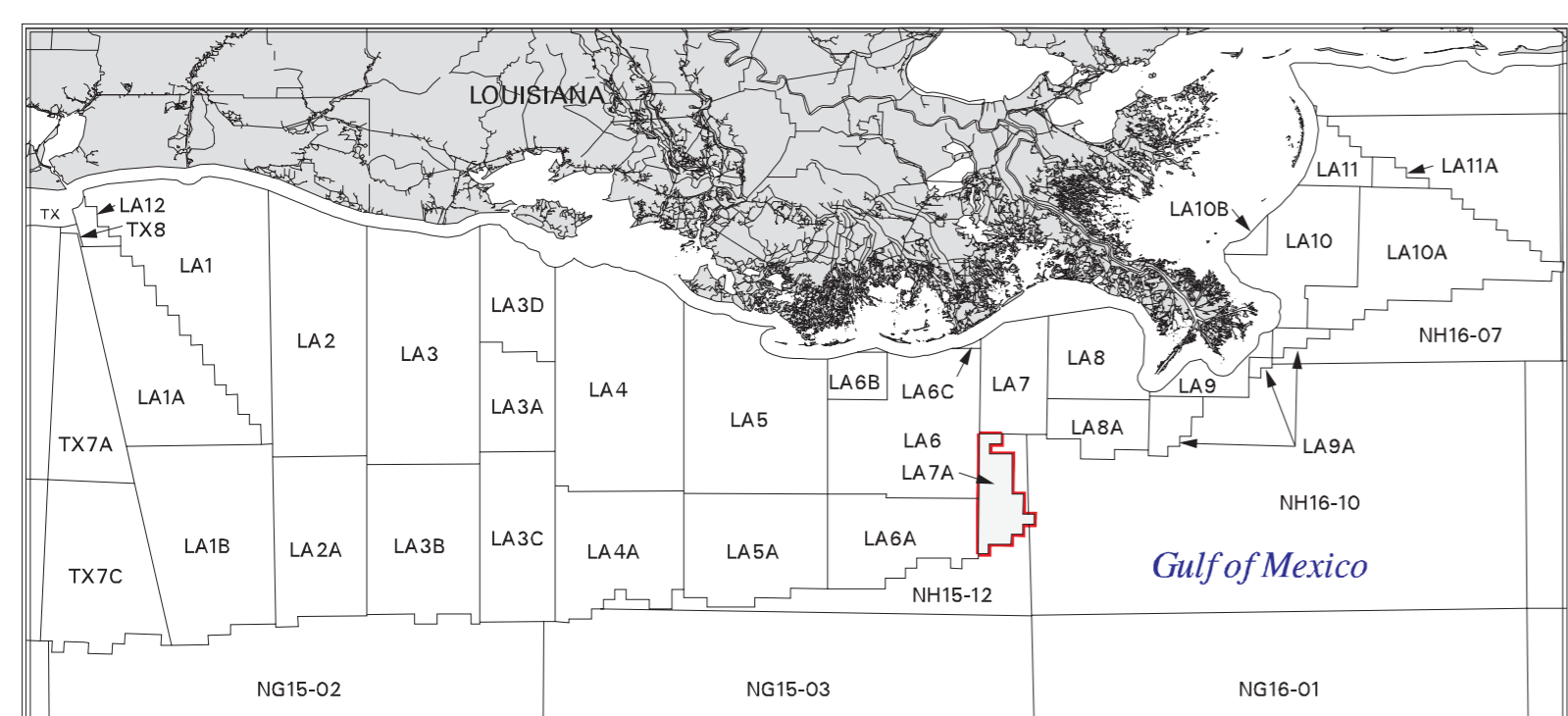

**LOUISIANA
GULF COAST INDEX**

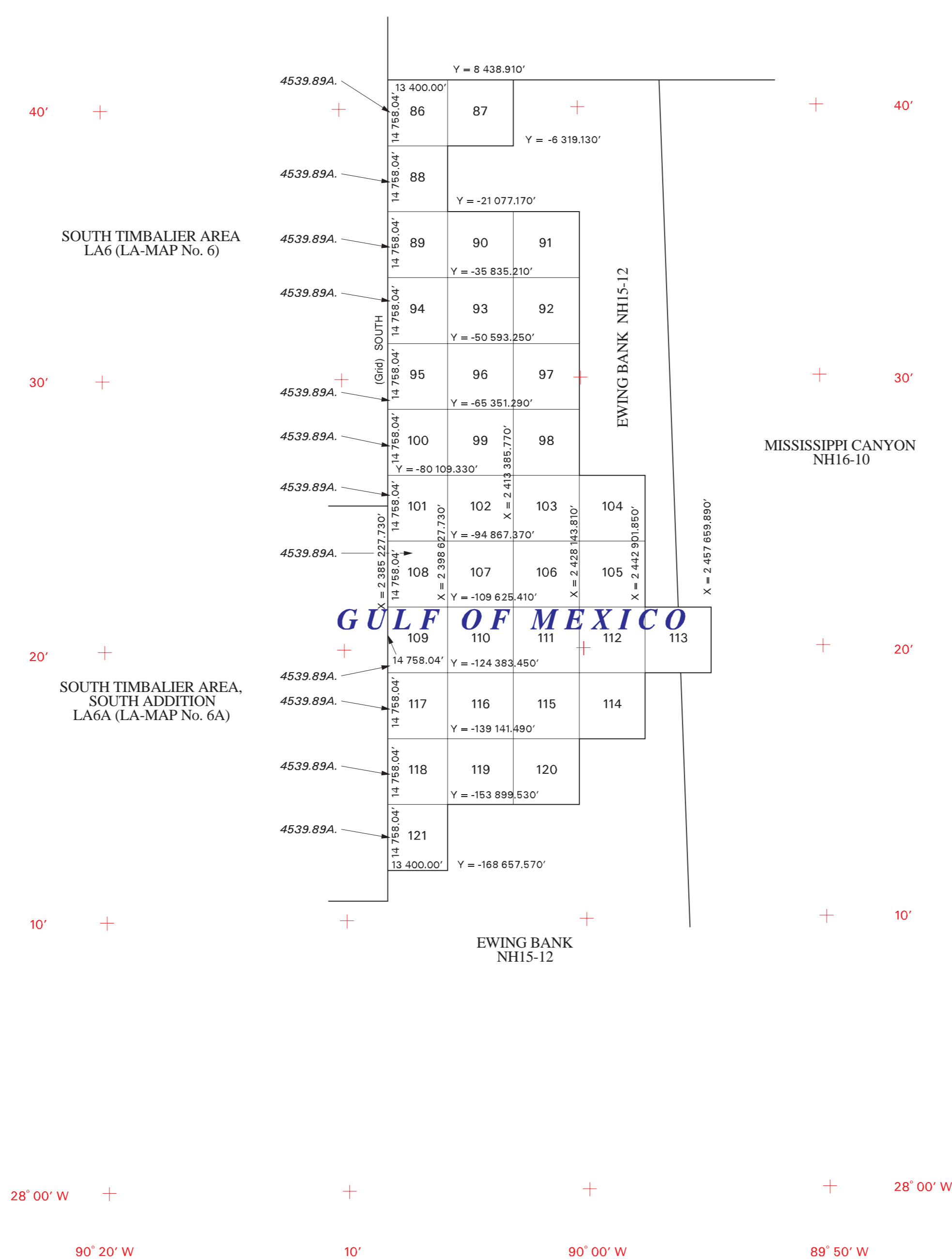

**GRAND ISLE AREA
LA7 (LA-MAP No. 7)**



All blocks are based on the Louisiana (Lambert) Plane Coordinate System, South Zone, with X origin = 2,000,000' at 91° 20' W and Y origin = 0.00' at 28° 40' N.

Regular blocks are 14,758.04 feet on a side and contain 5,000 acres. Areas and dimensions of the irregular blocks are as indicated.

This revised map supersedes leasing map GRAND ISLE AREA, SOUTH ADDITION, LA-MAP No. 7A, approved 08-SEP-1959, revised 07-MAR-1961, revised 01-JUN-1988, LA7A revised 01-SEP-1999 and LA7A revised 01-NOV-2000.

Copies of these diagrams and other information may be obtained at the appropriate MMS OCS Region.

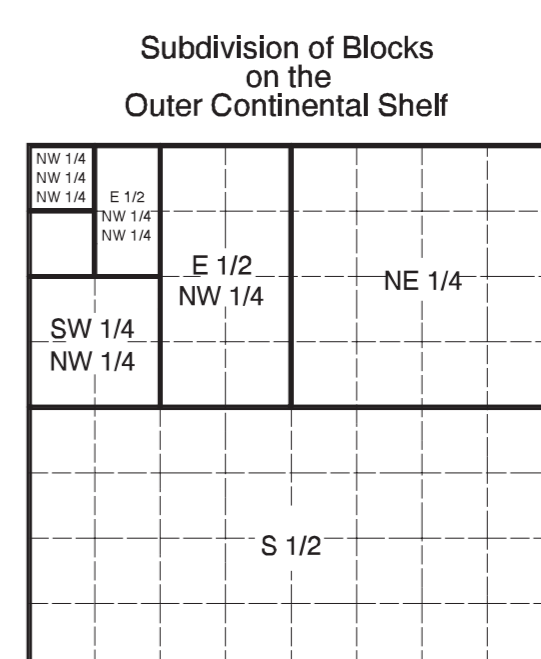

Typical method of subdivision of the regular blocks, each subdivision being an aliquot part of the total, based on midpoint subdivision throughout.

**UNITED STATES DEPARTMENT OF THE INTERIOR
MINERALS MANAGEMENT SERVICE
OUTER CONTINENTAL SHELF LEASING MAP
LOUISIANA
NORTH AMERICAN DATUM OF 1927**

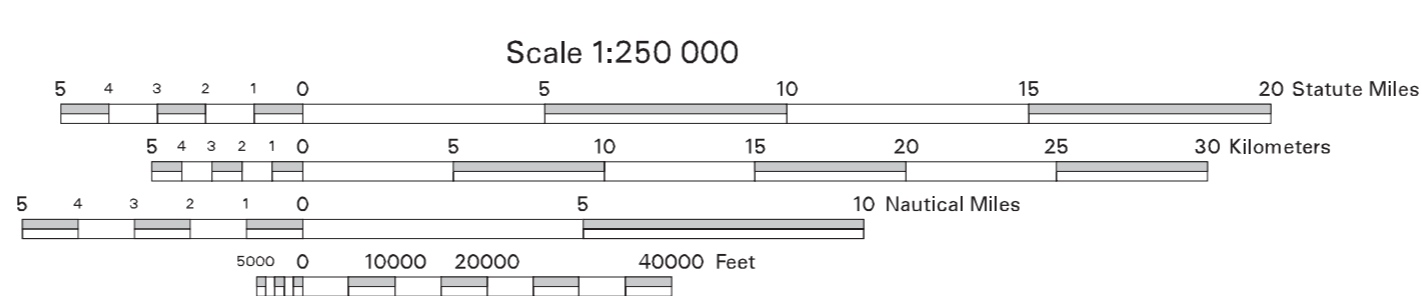

This diagram is prepared in accordance with 30 CFR 256.8

For the Director

Island H. Hama
Chief, Leasing Division, Mapping and Boundary Branch
Denver, Colorado Date 17-FEB-2004

Revised