

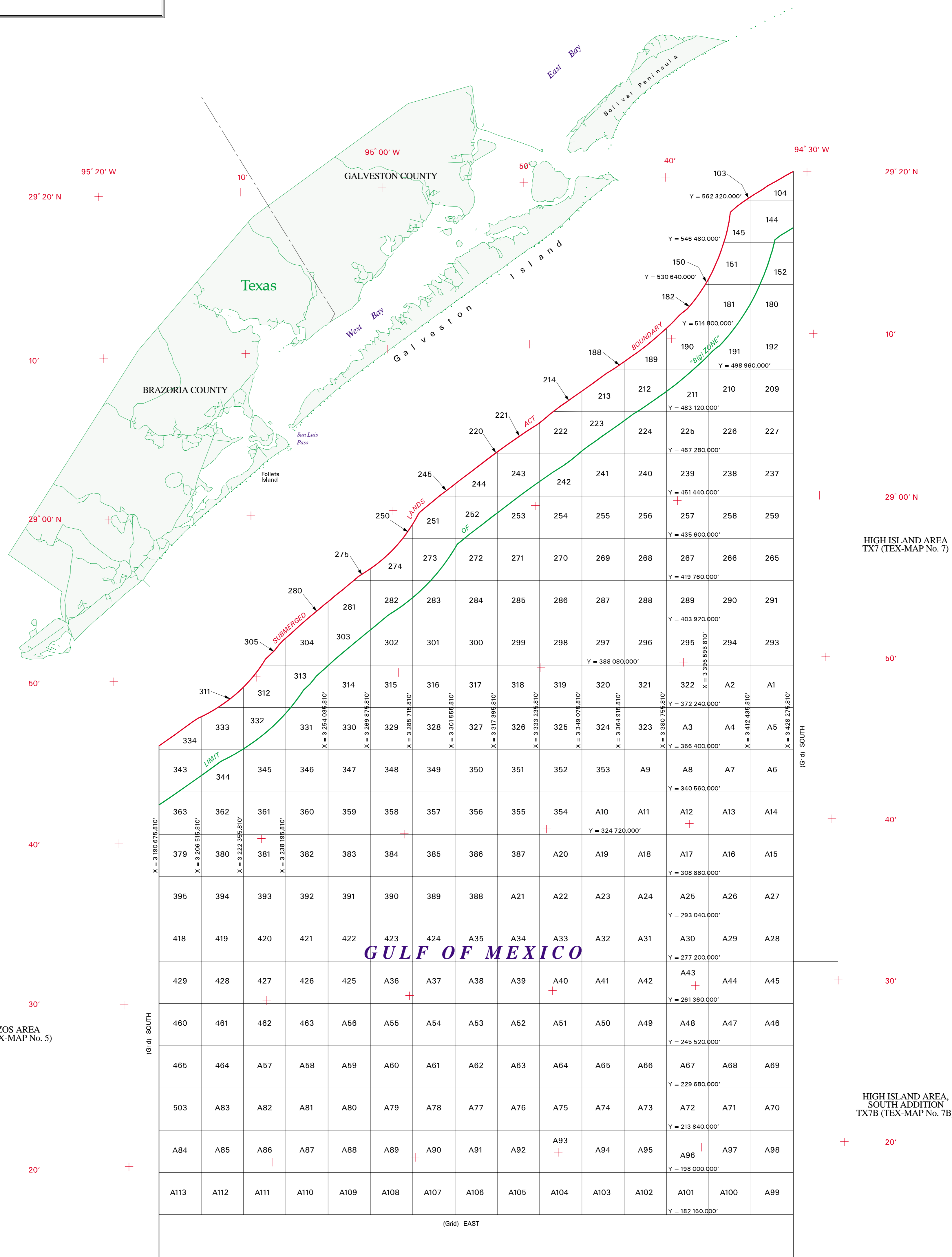

TEXAS
GULF COAST INDEX

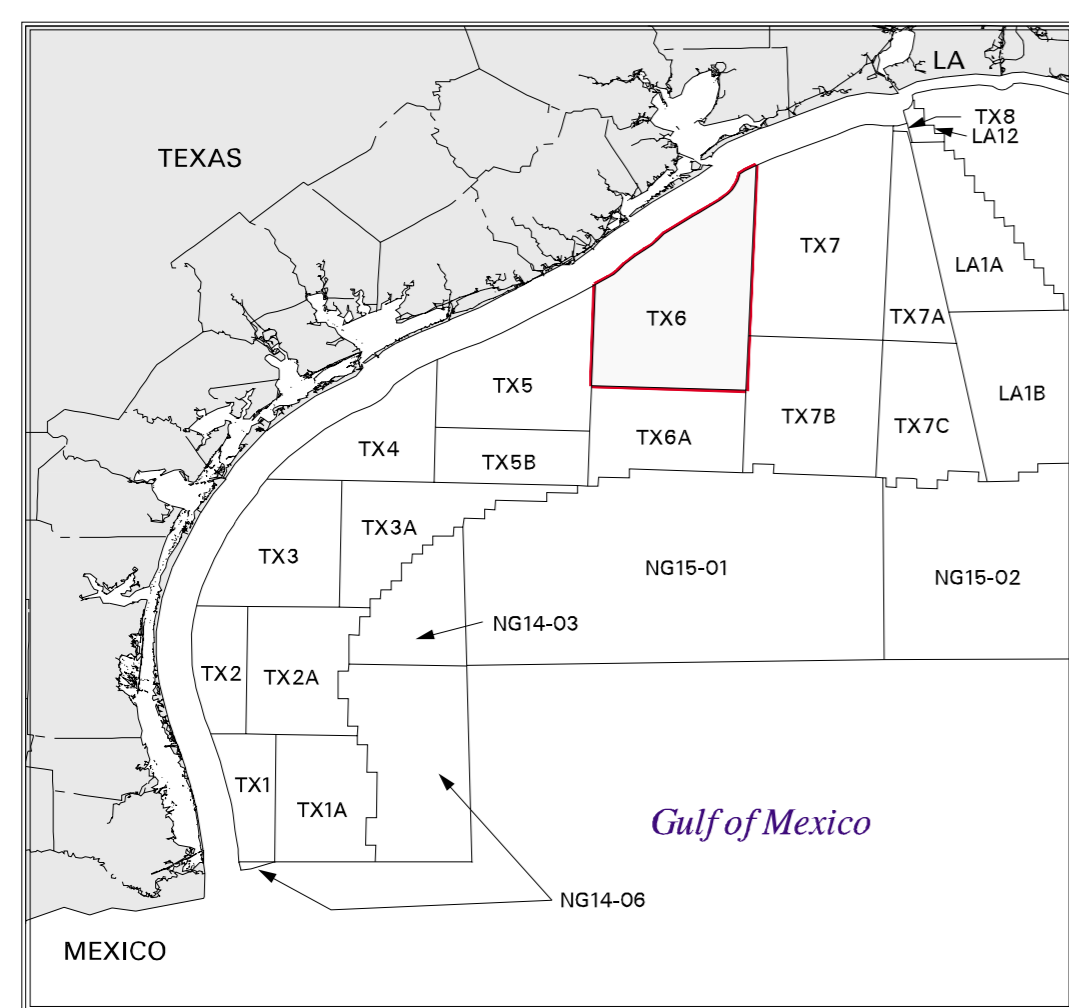

BRAZOS AREA
TX5 (TEX-MAP No. 5)

HIGH ISLAND AREA
TX7 (TEX-MAP No. 7)

HIGH ISLAND AREA,
SOUTH ADDITION
TX7B (TEX-MAP No. 7B)

GALVESTON AREA,
SOUTH ADDITION
TX6A (TEX-MAP No. 6A)

Subdivision of Blocks
on the
Outer Continental Shelf

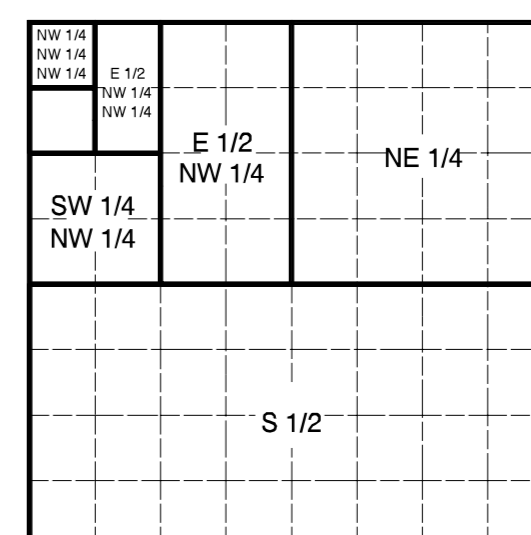

Typical method of subdivision of the regular blocks, each subdivision being an aliquot part of the total, based on midpoint subdivision throughout.

All blocks are based on the Texas (Lambert) Plane Coordinate System, South Central Zone, with X origin = 2,000,000' at 99° 00' W and Y origin = 000' at 27° 50' N.

Regular blocks are 15,840 feet on a side and contain 5,760 acres.

Onshore planimetric base compilation is from USCS 1:100,000 Digital Line Graph (DLG) files.

The Submerged Lands Act Boundary and Limit of "8(g) Zone" lines depicted hereon reflect the official federal position for Submerged Lands Act and OCS Lands Act purposes. The areas of the fractional blocks abutting these lines have been determined and are as depicted on the Supplemental Official OCS Block Diagrams (SOBD's). Consult the SOBD's for official descriptions and approval dates.

This revised map supersedes leasing map GALVESTON AREA, TEX-MAP No. 6, approved 16-JUL-1954, and TX6 revised 01-SEP-1999.

Copies of these diagrams and other information may be obtained at the appropriate MMS OCS Region.

UNITED STATES DEPARTMENT OF THE INTERIOR
MINERALS MANAGEMENT SERVICE

OUTER CONTINENTAL SHELF LEASING MAP
TEXAS

NORTH AMERICAN DATUM OF 1927

Scale 1:250,000

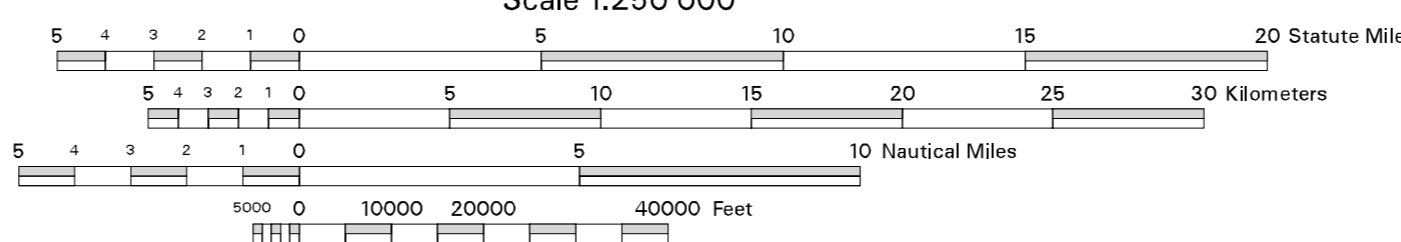

This diagram is prepared in accordance with 30 CFR 256.8

For the Director

Isabel Hernandez
Chief, Leasing Division, Mapping and Boundary Branch
Denver, Colorado Date 01-NOV-2000

Revised