

This map is based on U.S.G.S. quad Beechey Point (A-2, A-3, B-2, B-3) and on the Unit Operator's Facility Maps.



PROJECT LOCATION:

PRUDHOE BAY UNIT - LIBERTY MINE SITE

NAD83

LAT. = 70° 14' 30.03"

LONG. = -148° 11' 06.48"

ALASKA STATE PLANE ZONE 4, NAD 83

X = 1,864,732.90 FEET

Y = 5,941,043.61 FEET

ADL 028345 SECS. 6, 7 T10N, R16E

DATUM: MEAN SEA LEVEL

PURPOSE: MINE DEVELOPMENT

ADJACENT PROPERTY OWNER: STATE OF ALASKA

COUNTY: NORTH SLOPE BOROUGH

APPLICANT: BP EXPLORATION ALASKA, INC.

BP EXPLORATION (ALASKA) INC.

**LIBERTY DEVELOPMENT PROJECT
MINE SITE
VICINITY MAP**

DATE:
August 2007

SCALE:
1" = 3 Miles

FIGURE:
1

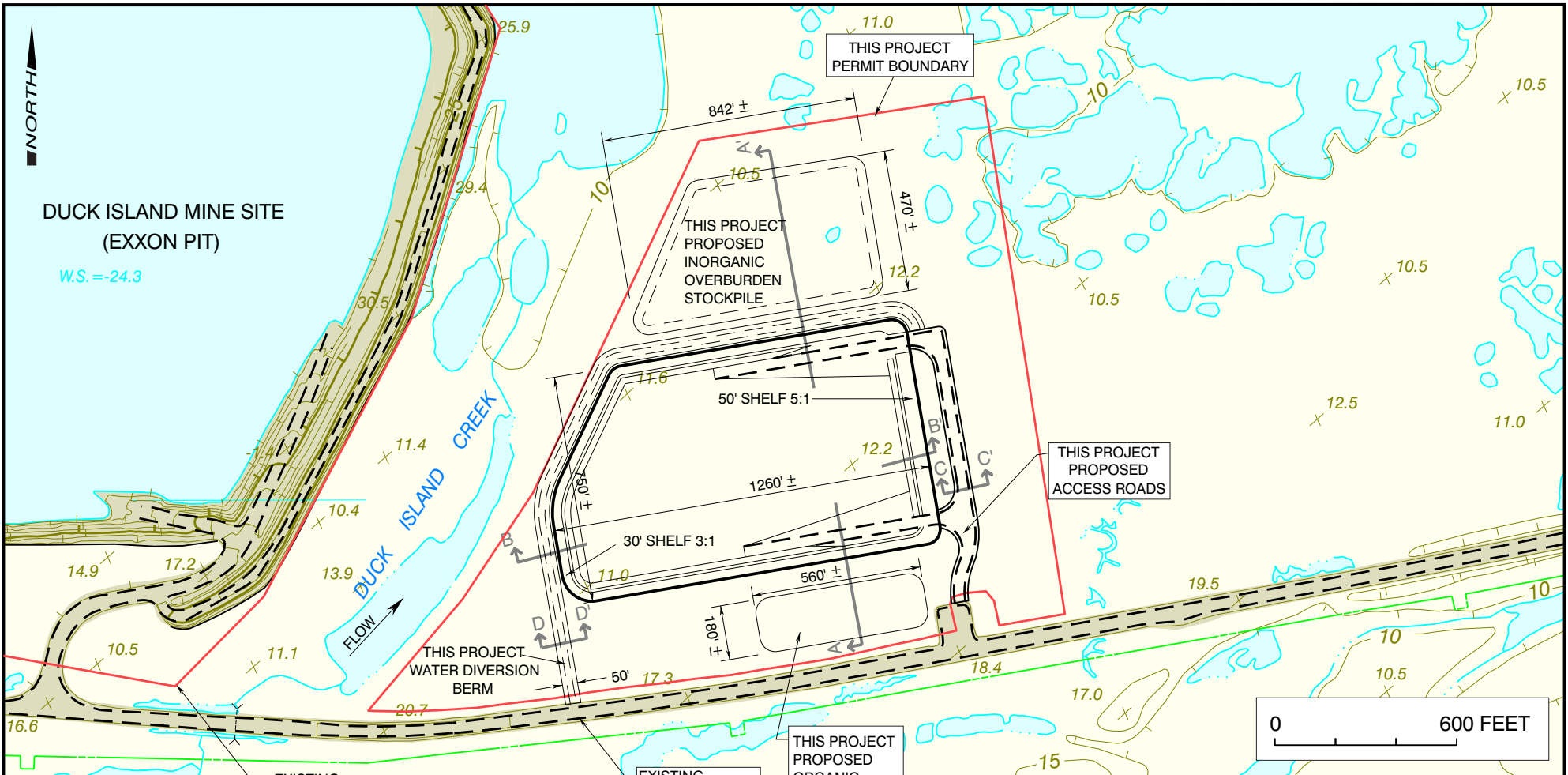

DUCK ISLAND MINE SITE
(EXXON PIT)

W.S. = -24.3

DUCK ISLAND CREEK
FLOW

THIS PROJECT
PERMIT BOUNDARY

THIS PROJECT
PROPOSED
INORGANIC
OVERBURDEN
STOCKPILE

THIS PROJECT
PROPOSED
ACCESS ROADS

THIS PROJECT
WATER DIVERSION
BERM

THIS PROJECT
PROPOSED
ORGANIC
OVERBURDEN
STOCKPILE

EXISTING
MINE BOUNDARY

EXISTING
ENDICOTT ROAD

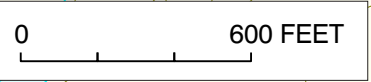

PROPOSED LIBERTY MINE SITE QUANTITIES

- PERMIT BOUNDARY AREA 63 ACRES
- EXCAVATION AREA 21 ACRES
- EXCAVATED VOLUME 1,000,000 CY
- ORGANIC OVERBURDEN STOCKPILE VOLUME 65,000 CY
- ORGANIC OVERBURDEN STOCKPILE FOOTPRINT 3 ACRES
- INORGANIC OVERBURDEN STOCKPILE VOLUME 240,000 CY
- INORGANIC OVERBURDEN STOCKPILE FOOTPRINT 8 ACRES
- WATER DIVERSION OVERBURDEN FOOTPRINT 3 ACRES
- WATER DIVERSION OVERBURDEN VOLUME 20,000 CY
- ACCESS ROAD FOOTPRINT 1.4 ACRES
- ACCESS ROAD VOLUME 12,000 CY

ALL LOCATIONS, DIMENSIONS AND QUANTITIES ARE APPROXIMATE

BP EXPLORATION (ALASKA) INC.

**LIBERTY DEVELOPMENT PROJECT
PROPOSED MINE SITE PLAN
LOCATION MAP**

DATE:
August 2007

SCALE:
1" = 500 Feet

FIGURE:
2

SOUTH

NORTH

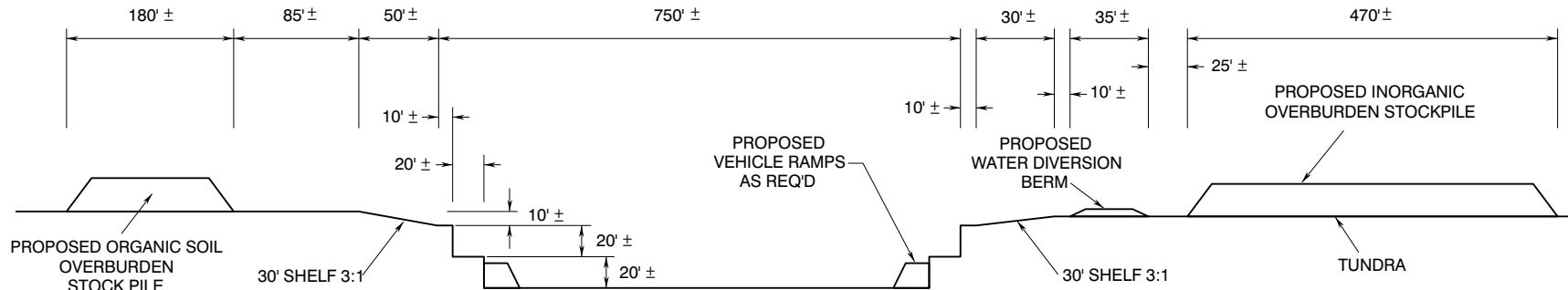

EXCAVATION CROSS SECTION A-A'

WEST

EAST

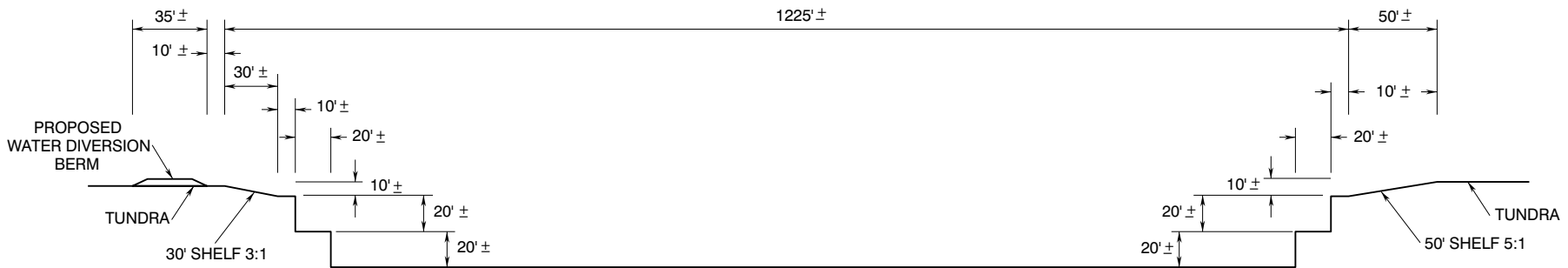

EXCAVATION CROSS SECTION B-B'

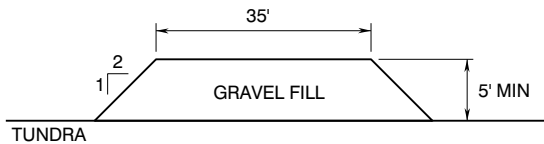

ACCESS ROAD CROSS SECTION C-C'

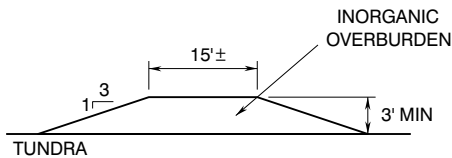

WATER DIVERSION BERM CROSS SECTION D-D'

ALL LOCATIONS AND DIMENSIONS ARE APPROXIMATE

BP EXPLORATION (ALASKA) INC.

LIBERTY DEVELOPMENT PROJECT
PROPOSED MINE SITE PLAN
CROSS SECTIONS

DATE:
August 2007

SCALE:
NOT TO SCALE

FIGURE:
3

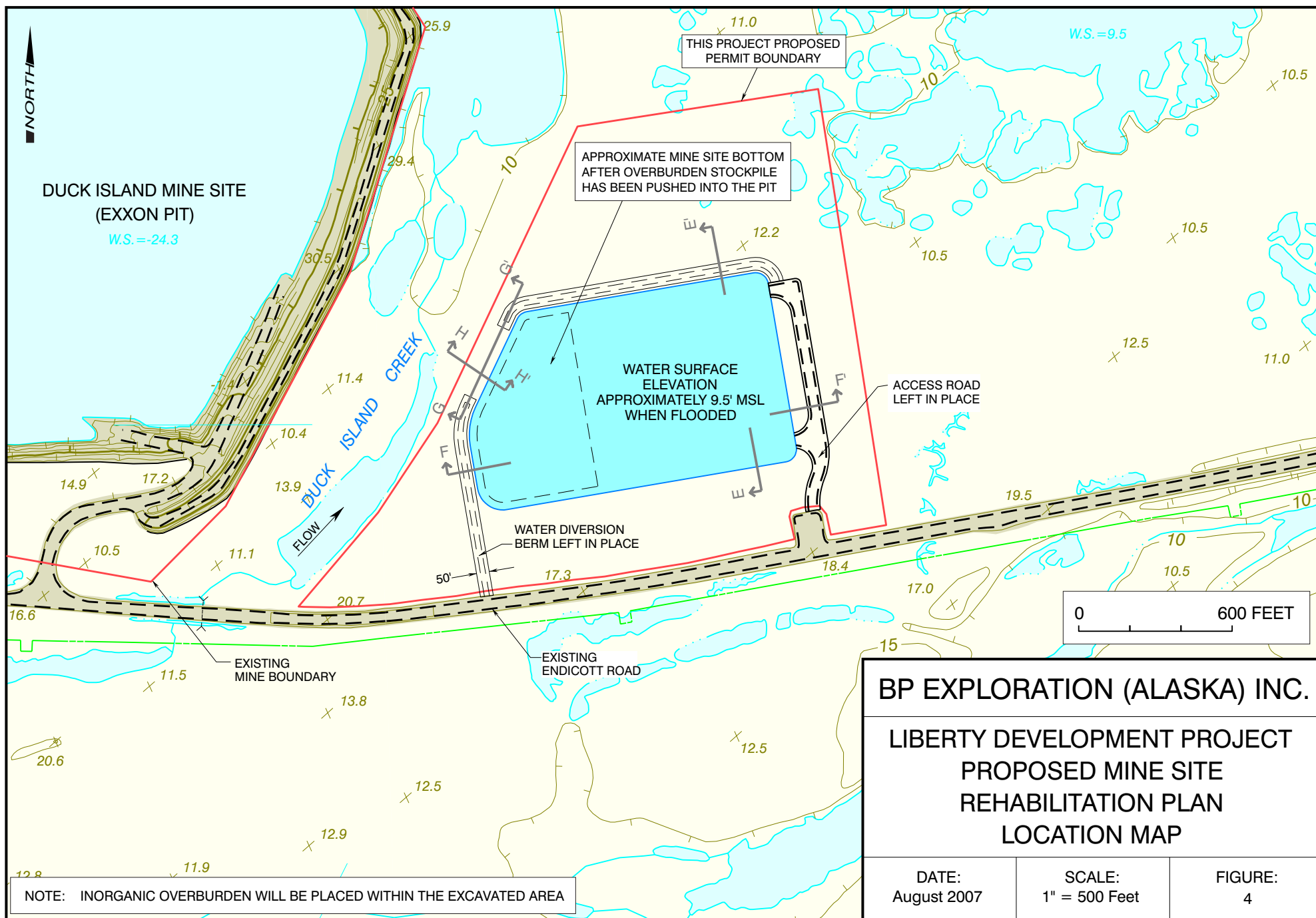

BP EXPLORATION (ALASKA) INC.

**LIBERTY DEVELOPMENT PROJECT
PROPOSED MINE SITE
REHABILITATION PLAN
LOCATION MAP**

DATE:
August 2007

SCALE:
1" = 500 Feet

FIGURE:
4

SOUTH

NORTH

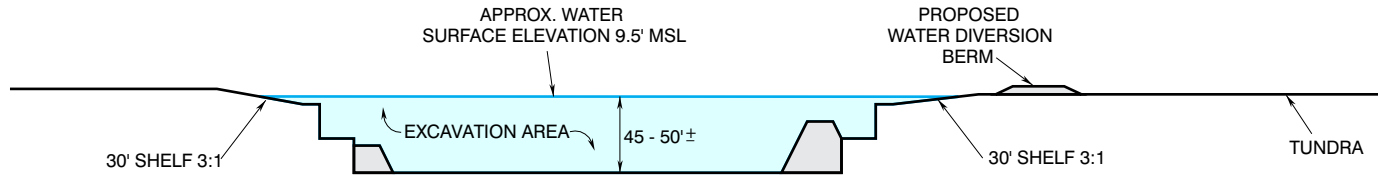

REHAB CROSS SECTION E-E'

WEST

EAST

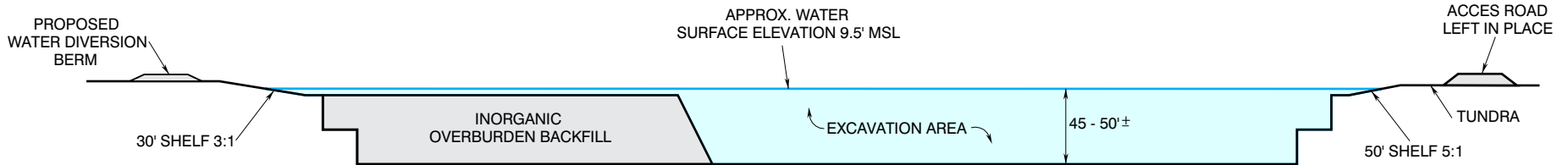

REHAB CROSS SECTION F-F'

ALL LOCATIONS AND DIMENSIONS ARE APPROXIMATE

BP EXPLORATION (ALASKA) INC.

LIBERTY DEVELOPMENT PROJECT
PROPOSED MINE SITE
REHABILITATION PLAN
CROSS SECTIONS

DATE:
August 2007

SCALE:
NOT TO SCALE

FIGURE:
5

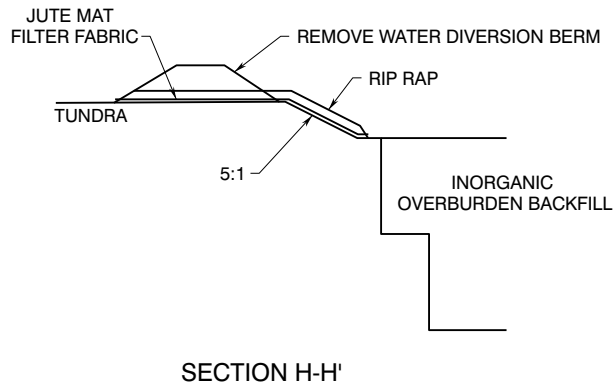
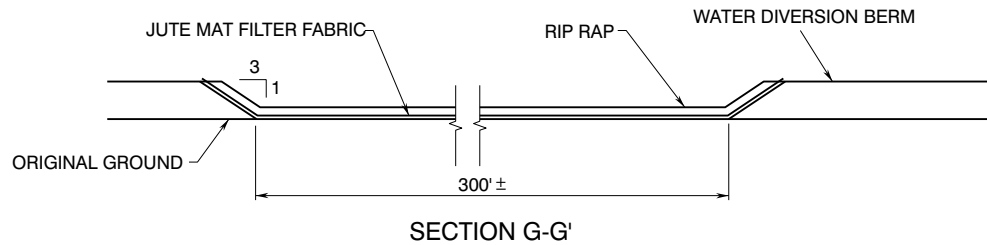

BP EXPLORATION (ALASKA) INC.

**LIBERTY DEVELOPMENT PROJECT
PROPOSED MINE SITE
REHABILITATION PLAN
CROSS SECTIONS**

ALL LOCATIONS AND DIMENSIONS ARE APPROXIMATE

DATE:
August 2007

SCALE:
NOT TO SCALE

FIGURE:
6