

UNITED STATES DEPARTMENT OF INTERIOR  
MINERALS MANAGEMENT SERVICE

SUPPLEMENTAL OFFICIAL  
OCS 8-G BLOCK DIAGRAM

SALE NO. \_\_\_\_\_  
☐ FED.-STATE SEAWARD BDY.  
RADIUS \_\_\_\_\_  
☒ 8-G BOUNDARY  
RADIUS 36 468.91'

South  
OPD NAME Pelto Area  
OPD NO. LA Map 6B  
BLOCK NO. 7  
OCS LEASE NO. \_\_\_\_\_  
STATE LEASE NO. \_\_\_\_\_

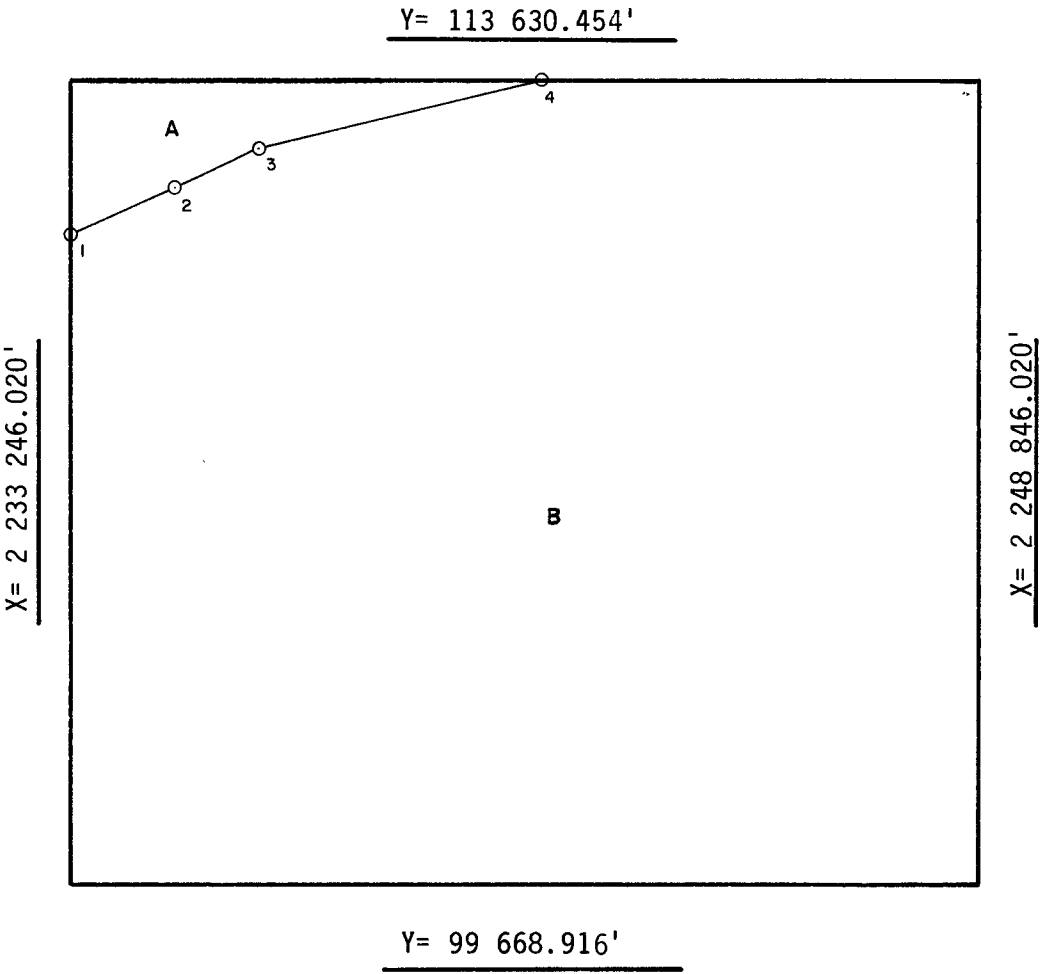

INTERSECTIONS

ARC CENTERS

	X	Y		X	Y
1	2 233 246.020'	110 964.022'	*1-2	2 218 146'	144 160'
2	2 234 992.36'	111 755.68'	2-3	2 219 935'	144 971'
3	2 236 423.16'	112 442.21'	*3-4	2 222 957'	146 695'
4	2 241 291.786'	113 630.454'			

\*TANGENT SEGMENT

FEDERAL AREA B= 4792.05A STATE AREA \_\_\_\_\_ 8G AREA A= 207.95A DISPUTED AREA \_\_\_\_\_  
% \_\_\_\_\_ % \_\_\_\_\_ % \_\_\_\_\_ % \_\_\_\_\_

COMPUTATIONS BY FLDC DATE 11-4-85  
DRAFTED BY QV DATE 5-29-86  
CHECKED BY TH DATE 1-12-87

FOR THE DIRECTOR  
Telma H. Hunsbaker  
DATE 5-16-87

FOR THE STATE  
\_\_\_\_\_  
DATE \_\_\_\_\_