

UNITED STATES
DEPARTMENT OF THE INTERIOR
BUREAU OF LAND MANAGEMENT

OIL AND GAS LEASE OF SUBMERGED LANDS
UNDER THE OUTER CONTINENTAL SHELF LANDS ACT

Office	Serial number
Los Angeles, CA	OCS-P 0316
Cash bonus	Rental rate
\$36,569,421.30	\$3.00 per acre
Minimum royalty rate	Royalty rate
\$3.00 per acre	16 2/3%
Work commitment	Profit share rate

This lease is effective as of **SEP 1 1979** (hereinafter called the "Effective Date") by and between the United States of America (hereinafter called the "Lessor"), by the Manager, Pacific OCS Office, Bureau of Land Management, its authorized officer, and

Chevron U.S.A. Inc.
Phillips Petroleum Company
Champlin Petroleum Company
ICI Delaware Inc.

40.00000 %
40.00000 %
10.00000 %
10.00000 %



(hereinafter called the "Lessee"). In consideration of any cash payment heretofore made by the Lessee to the Lessor and in consideration of the promises, terms, conditions, and covenants contained herein, including the Stipulation(s) numbered 1-A, 2, 3, 4, 5, 6, 9 and 13 attached hereto, the Lessee and Lessor agree as follows:

Sec. 1. Statutes and Regulations. This lease is issued pursuant to the Outer Continental Shelf Lands Act of August 7, 1953, 67 Stat. 462 as amended; 43 U.S.C. 1331 et. seq. (hereinafter called the "Act"). The lease is issued subject to the Act; Sections 302 and 303 of the Department of Energy Organization Act, 91 Stat. 578, 42 U.S.C. 7152 and 7153; all regulations issued pursuant to such statutes and in existence upon the effective date of this lease; all regulations issued pursuant to such statutes in the future which provide for the prevention of waste and the conservation of the natural resources of the Outer Continental Shelf, and the protection of correlative rights therein; and all other applicable statutes and regulations.

Sec. 2. Rights of Lessee. The Lessor hereby grants and leases to the Lessee the exclusive right and privilege to drill for, develop, and produce oil and gas resources, except helium gas, in the submerged lands of the Outer Continental Shelf described as follows:

All Block 55N 84W, OCS Leasing Map, Channel Islands Area, CAL-Map No. 6A.

containing approximately 4177.93 acres or
These rights include:

(a) the nonexclusive right to conduct within the leased area geological and geophysical explorations in accordance with applicable regulations;

(b) the nonexclusive right to drill water wells within the leased area, unless the water is part of geopressured-geothermal and associated resources, and to use the water produced therefrom for operations pursuant to the Act free of cost, on the condition that the drilling is conducted in accordance with procedures approved by the Director of the United States Geological Survey or the Director's delegate (hereinafter called the "Director"); and

(c) the right to construct or erect and to maintain within the leased area artificial islands, installations, and other devices permanently or temporarily attached to the seabed and other works and structures necessary to the full enjoyment of the lease, subject to compliance with applicable laws and regulations.

Sec. 3. Term. This lease shall continue for an initial period of five years from the Effective Date of the lease and so long thereafter as oil or gas is produced from the leased area in paying quantities, or drilling or well reworking operations, as approved by the Lessor, are conducted thereon.

Sec. 4. Rentals. The Lessee shall pay the Lessor, on or before the first day of each lease year which commences prior to a discovery in paying quantities of oil or gas on the leased area, a rental of \$3.00 per acre (per hectare) or fraction thereof.

Sec. 5. Minimum Royalty. The Lessee shall pay the Lessor at the expiration of each lease year which commences after a discovery of oil and gas in paying quantities, a minimum royalty of \$3.00 per acre (per hectare) or fraction thereof or, if there is production, the difference between the actual royalty required to be paid with respect to such lease year and the prescribed minimum royalty, if the actual royalty paid is less than the minimum royalty.

Sec. 6. Royalty on Production. (a) The Lessee shall pay a fixed royalty of 16-2/3 percent in amount or value of production saved, removed, or sold from the leased area. Gas of all kinds (except helium) is subject to royalty. The Lessor shall determine whether production royalty shall be paid in amount or value.

(b) The value of production for purposes of computing royalty on production from this lease shall never be less than the fair market value of the production. The value of production shall be the estimated reasonable value of the production as determined by the Lessor, due consideration being given to the highest price paid for a part or for a majority of production of like quality in the same field or area, to the price received by the Lessee, to posted prices, to regulated prices, and to other relevant matters. Except when the Lessor, in its discretion, determines not to consider special pricing relief from otherwise applicable Federal regulatory requirements, the value of production for the purposes of computing royalty shall not be deemed to be less than the gross proceeds accruing to the Lessee from the sale thereof. In the absence of good reason to the contrary, value computed on the basis of the highest price paid or offered at the time of production in a fair and open market for the major portion of like-quality products produced and sold from the field or area where the leased area is situated, will be considered to be a reasonable value.

(c) When paid in value, royalties on production shall be due and payable monthly on the last day of the month next following the month in which the production is obtained, unless the Lessor designates a later time. When paid in amount, such royalties shall be delivered at pipeline connections or in tanks provided by the Lessee. Such deliveries shall be made at reasonable times and intervals and, at the Lessor's option, shall be effected either (i) on or immediately adjacent to the leased area, without cost to the Lessor, or (ii) at a more convenient point closer to shore or on shore, in which event the Lessee shall be entitled to reimbursement for the reasonable cost of transporting the royalty substance to such delivery point. The Lessee shall not be required to provide storage for royalty paid in amount in excess of tankage required when royalty is paid in value. When royalties are paid in amount, the Lessee shall not be held liable for the loss or destruction of royalty oil or other liquid products in storage from causes over which the Lessee has no control.

Sec. 7. Payments. The Lessee shall make all payments to the Lessor by check, bank draft, or money order unless otherwise provided by regulations or by direction of the Lessor. Rentals, royalties, and any other payments required by this lease shall be made payable to the United States Geological Survey and tendered to the Director, except that filing charges, bonuses, first year's rental, and other payments due upon lease issuance, shall be made payable to the Bureau of Land Management and remitted to the Manager of the appropriate field office of that Bureau.

Sec. 8. Bonds. The Lessee shall maintain at all times the bond(s) required by regulation prior to the issuance of the lease and shall furnish such additional security as may be required by the Lessor if, after operations have begun, the Lessor deems such additional security be necessary.

hectares (hereinafter referred to as the "leased area").

Sec. 9. Plans. The Lessee shall conduct all operations on the leased area in accordance with approved exploration plans, and approved development and production plans as are required by regulations. The Lessee may depart from an approved plan only as provided by applicable regulations.

Sec. 10. Performance. The Lessee shall comply with all regulations and orders relating to exploration, development, and production. After due notice in writing, the Lessee shall drill such wells and produce at such rates as the Lessor may require in order that the leased area or any part thereof may be properly and timely developed and produced in accordance with sound operating principles.

Sec. 11. Directional Drilling. A directional well drilled under the leased area from a surface location on nearby land not covered by this lease shall be deemed to have the same effect for all purposes of the lease as a well drilled from a surface location on the leased area. In those circumstances, drilling shall be considered to have been commenced on the leased area when drilling is commenced on the nearby land for the purpose of directionally drilling under the leased area, and production of oil or gas from the leased area through any directional well surfaced on nearby land or drilling or reworking of any such directional well shall be considered production or drilling or reworking operations on the leased area for all purposes of the lease. Nothing contained in this Section shall be construed as granting to the Lessee any interest, license, easement, or other right in any nearby land.

Sec. 12. Safety Requirements. The Lessee shall (a) maintain all places of employment within the leased area in compliance with occupational safety and health standards and, in addition, free from recognized hazards to employees of the Lessee or of any contractor or subcontractor operating within the leased area;

(b) maintain all operations within the leased area in compliance with regulations intended to protect persons, property, and the environment on the Outer Continental Shelf; and

(c) allow prompt access, at the site of any operation subject to safety regulations, to any authorized Federal inspector and shall provide any documents and records which are pertinent to occupational or public health, safety, or environmental protection as may be requested.

Sec. 13. Suspension and Cancellation. (a) The Lessor may suspend or cancel this lease during the initial lease term or thereafter pursuant to Section 5 of the Act and compensation shall be paid when provided by the Act.

(b) The Lessor may, upon recommendation of the Secretary of Defense, during a state of war or national emergency declared by Congress or the President of the United States, suspend operations under the lease, as provided in Section 12(c) of the Act, and just compensation shall be paid to the Lessee for such suspension.

Sec. 14. Indemnification. The Lessee shall indemnify the Lessor for, and hold it harmless from, any claim, including claims for loss or damage to property or injury to persons caused by or resulting from any operation on the leased area conducted by or on behalf of the Lessee. However, the Lessee shall not be held responsible to the Lessor under this section for any loss, damage, or injury caused by or resulting from:

(a) negligence of the Lessor other than the commission or omission of a discretionary function or duty on the part of a Federal agency whether or not the discretion involved is abused; or

(b) the Lessee's compliance with an order or directive of the Lessor against which an administrative appeal by the Lessee is filed before the cause of action for the claim arises and is pursued diligently thereafter.

Sec. 15. Disposition of Production. (a) As provided in Section 27(a)(2) of the Act, the Lessor shall have the right to purchase not more than 16-2/3 percent by volume of the oil and gas produced pursuant to the lease at the regulated price, or if no regulated price applies, at the fair market value at the well head of the oil and gas saved, removed, or sold, except that any oil or gas obtained by the Lessor as royalty or net profit share shall be credited against the amount that may be purchased under this subsection.

(b) As provided in Section 27(d) of the Act, the Lessee shall take any Federal oil or gas for which no acceptable bids are received, as determined by the Lessor, and which is not transferred to a Federal agency pursuant to Section 27(a)(3) of the Act, and shall pay to the Lessor a cash amount equal to the regulated price, or if no regulated price applies, the fair market value of the oil or gas so obtained.

(c) As provided in Section 8(b)(7) of the Act, the Lessee shall offer 20 percent of the crude oil, condensate, and natural gas liquids produced on the lease, at the market value and point of delivery as provided by regulations applicable to Federal royalty oil, to small or independent refiners as defined in the Emergency Petroleum Allocation Act of 1973.

(d) In time of war, or when the President of the United States shall so prescribe, the Lessor shall have the right of first refusal to purchase at the market price all or any portion of the oil or gas produced from the leased area, as provided in Section 12(b) of the Act.

UNITED STATES
DEPARTMENT OF THE INTERIOR
BUREAU OF LAND MANAGEMENT

Stipulations for Oil and Gas Lease Sale #48
Outer Continental Shelf
Southern California

TRACT NO. 48-004 BLOCK NO. 55N 84W MAP NO. CAL 6A OCS-P 0316

The area described in Section 2 of this instrument is subject to the following stipulation:

Stipulation No. 9

Exploratory drilling operations, emplacement of structures (platforms) or seafloor wellheads for production or storage of oil or gas, and the emplacement of pipelines will not be allowed within the potentially unstable portion of this lease block unless or until the lessee has demonstrated to the Supervisor's satisfaction that mass movement of sediments is unlikely or that exploratory drilling operations, structures (platforms), casing, wellheads and pipelines can be safely designed to protect the environment in case such mass movement occurs at the proposed location. If exploratory drilling operations are allowed, site specific surveys shall be conducted to determine the potential for mass movement of sediments. If emplacement of structures (platforms) or seafloor wellheads for production or storage of oil or gas are allowed all potential mass movements of sediments in the lease block must be mapped. Down-hole pressure actuated control devices must be located below the base of the potentially unstable sediments located in the area in order to protect the environment in case such mass movement occurs at the proposed location. This may necessitate all exploration for and development of oil and gas be performed from locations outside of the area of unstable sediments, either within or outside of this lease block.

UNITED STATES
DEPARTMENT OF THE INTERIOR
BUREAU OF LAND MANAGEMENT

Stipulations for Oil and Gas Lease Sale #48
Outer Continental Shelf
Southern California

TRACT NO. 48-004 BLOCK NO. 55N 84W MAP NO. CAL 6A OCS-P 0316

The area described in Section 2 of this instrument is subject to the following stipulation:

Stipulation No. 13

No producing well may be drilled so that the well bore in the producing intervals is closer than 500 feet to the seaward boundary of the State except that the 500 feet constraint shall not apply:

(a) If oil or gas pools or fields underlying both the Outer Continental Shelf and lands subject to the the jurisdiction of California are included in a production unit entered into by the relevant lessees and approved by the lessors.

(b) If, in the absence of a production unit as described in (a) above, the State of California permits production from State lands from a point closer than 500 feet from the Federal-State boundary. In the event that such production from State lands does occur, the Federal lessee shall be allowed to produce from offset wells equally close to the boundary in the area of Federal jurisdiction.

Sec. 16. Unitization, Pooling, and Drilling Agreements. Within such time as the Lessor may prescribe, the Lessee shall subscribe to and operate under a unit, pooling, or drilling agreement embracing all or part of the lands subject to this lease as the Lessor may determine to be appropriate or necessary. Where any provision of a unit, pooling, or drilling agreement, approved by the Lessor, is inconsistent with a provision of this lease, the provision of the agreement shall govern.

Sec. 17. Equal Opportunity Clause. During the performance of this lease, the Lessee shall fully comply with paragraphs (1) through (7) of Section 202 of Executive Order 11246, as amended (reprinted in 41 CFR 60-1.4(a)), and the implementing regulations, which are for the purpose of preventing employment discrimination against persons on the basis of race, color, religion, sex, or national origin. Paragraphs (1) through (7) of Section 202 of Executive Order 11246, as amended, are incorporated in this lease by reference.

Sec. 18. Certification of Nonsegregated Facilities. By entering into this lease, the Lessee certifies, as specified in 41 CFR 60-1.8, that it does not and will not maintain or provide for its employees any segregated facilities at any of its establishments, and that it does not and will not permit its employees to perform their services at any location under its control where segregated facilities are maintained. As used in this certification, the term "segregated facilities" means, but is not limited to, any waiting rooms, work areas, rest rooms and wash rooms, restaurants and other eating areas, areas, time clocks, locker rooms and other storage or dressing areas, parking lots, drinking fountains, recreation or entertainment areas, transportation, and housing facilities provided for employees which are segregated by explicit directive or are in fact segregated on the basis of race, color, religion, or national origin, because of habit, local custom, or otherwise. The Lessee further agrees that it will obtain identical certifications from proposed contractors and subcontractors prior to award of contracts or subcontracts unless they are exempt under 41 CFR 60-1.5.

Sec. 19. Reservations to Lessor. All rights in the leased area not expressly granted to the Lessee by the Act, the regulations, or this lease are hereby reserved to the Lessor. Without limiting the generality of the foregoing, reserved rights include:

(a) the right to authorize geological and geophysical exploration in the leased area which does not unreasonably interfere with or endanger actual operations under the lease, and the right to grant such easements or rights-of-way upon, through, or in the leased area as may be necessary or appropriate to the working of other lands or to the treatment and shipment of products thereof by or under authority of the Lessor;

(b) the right to grant leases for any minerals other than oil and gas within the leased area, except that operations under such leases shall not unreasonably interfere with or endanger operations under this lease;

(c) the right, as provided in Section 12(d) of the Act, to restrict operations in the leased area or any part thereof which may be designated by the Secretary of Defense, with approval of the President, as being with an area needed for national defense, and so long as such designation remains in effect no operations may be conducted on the surface of the leased area or the part thereof included within the designation except with the concurrence of the Secretary of Defense. If operations or production under this lease within, any design-

ated area are suspended pursuant to this paragraph, any payments of rentals or royalty prescribed by this lease likewise shall be suspended during such period of suspension of operations and production, and the term of this lease shall be extended by adding thereto any such suspension period, and the Lessor shall be liable to the Lessee for such compensation as is required to be paid under the Constitution of the United States.

Sec. 20. Transfer of Lease. The Lessee shall file for approval with the appropriate field office of the Bureau of Land Management any instrument of assignment or other transfer of this lease, or any interest therein, in accordance with applicable regulations.

Sec. 21. Surrender of Lease. The Lessee may surrender this entire lease or any officially designated subdivision of the leased area by filing with the appropriate field office of the Bureau of Land Management a written relinquishment, in triplicate, which shall be effective as of the date of filing. No surrender of this lease or of any portion of the leased area shall relieve the Lessee or its surety of the obligation to pay all accrued rentals, royalties, and other financial obligations or to abandon all wells on the area to be surrendered in a manner satisfactory to the Director.

Sec. 22. Removal of Property on Termination of Lease. Within a period of one year after termination of this lease in whole or in part, the Lessee shall remove all devices, works, and structures from the premises no longer subject to the lease in accordance with applicable regulations and orders of the Director. However, the Lessee may, with the approval of the Director, continue to maintain devices, works, and structures on the leased area for drilling or producing on other leases.

Sec. 23. Remedies in Case of Default. (a) Whenever the Lessee fails to comply with any of the provisions of the Act, the regulations issued pursuant to the Act, or the terms of this lease, the lease shall be subject to cancellation in accordance with the provisions of Section 5(c) and (d) of the Act and the Lessor may exercise any other remedies which the Lessor may have, including the penalty provisions of Section 24 of the Act. Furthermore, pursuant to Section 8(o) of the Act, the Lessor may cancel the lease if it is obtained by fraud or misrepresentation.

(b) Nonenforcement by the Lessor of a remedy for any particular violation of the provisions of the Act, the regulations issued pursuant to the Act, or the terms of this lease shall not prevent the cancellation of this lease or the exercise of any other remedies under paragraph (a) of this section for any other violation or for the same violation occurring at any other time.

Sec. 24. Unlawful Interest. No member of, or Delegate to, Congress, or Resident Commissioner, after election or appointment, or either before or after they have qualified, and during this continuance in office, and no officer, agent, or employee of the Department of the Interior, except as provided in 43 CFR Part 7, shall be admitted to any share or part in this lease or derive any benefit that may arise therefrom. The provisions of Section 3741 of the Revised Statutes, as amended, 41 U.S.C. 22, and the Act of June 25, 1948, 62 Stat. 702, as amended, 18 U.S.C. 431-433, relating to contracts made or entered into, or accepted by or on behalf of the United States, from a part of this lease insofar as they may be applicable.

CHEVRON U.S.A. INC.

(Lessee)

By:

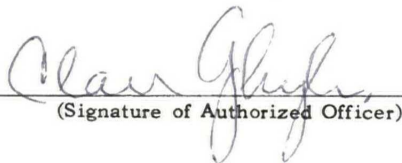
(Signature of Authorized Officer)

CLAIR GHYLIN

(Name of Signatory)

Its Attorney-in-Fact

(Title)

EVIDENCE OF AUTHORITY OF ATTORNEY-IN-FACT TO ACT FOR PRINCIPAL
IS FILED IN L.A. 1078 SUCH AUTHORITY IS STILL IN EFFECT.

August 8, 1979

(Date)

P. O. Box 7643
San Francisco, CA 94120

(Address of Lessee)

THE UNITED STATES OF AMERICA, Lessor

(Signature of Authorized Officer)

WILLIAM E. GRANT

(Name of Signatory)

Manager, Pacific OCS Office
Bureau of Land Management

(Title)

AUG 28 1979

(Date)

(Signature of Lessee)

(Signature of Lessee)

(Signature of Lessee)

(Signature of Lessee)

(Signature of Lessee)

(Signature of Lessee)

(Signature of Lessee)

(Signature of Lessee)

(Signature of Lessee)

(Signature of Lessee)

(Signature of Lessee)

(Signature of Lessee)

(Signature of Lessee)

SUPPLEMENTAL OFFICIAL
OCS 8-G BLOCK DIAGRAM

Channel

OPD NAME Islands Area
OPD NO. CAL Map No. 6A
BLOCK NO. 55N-84W
OCS LEASE NO. _____
STATE LEASE NO. _____

SALE NO. 80
FED. - STATE SEAWARD BDY. _____
RADIUS _____
B-G BOUNDARY _____
RADIUS 36 456.62'

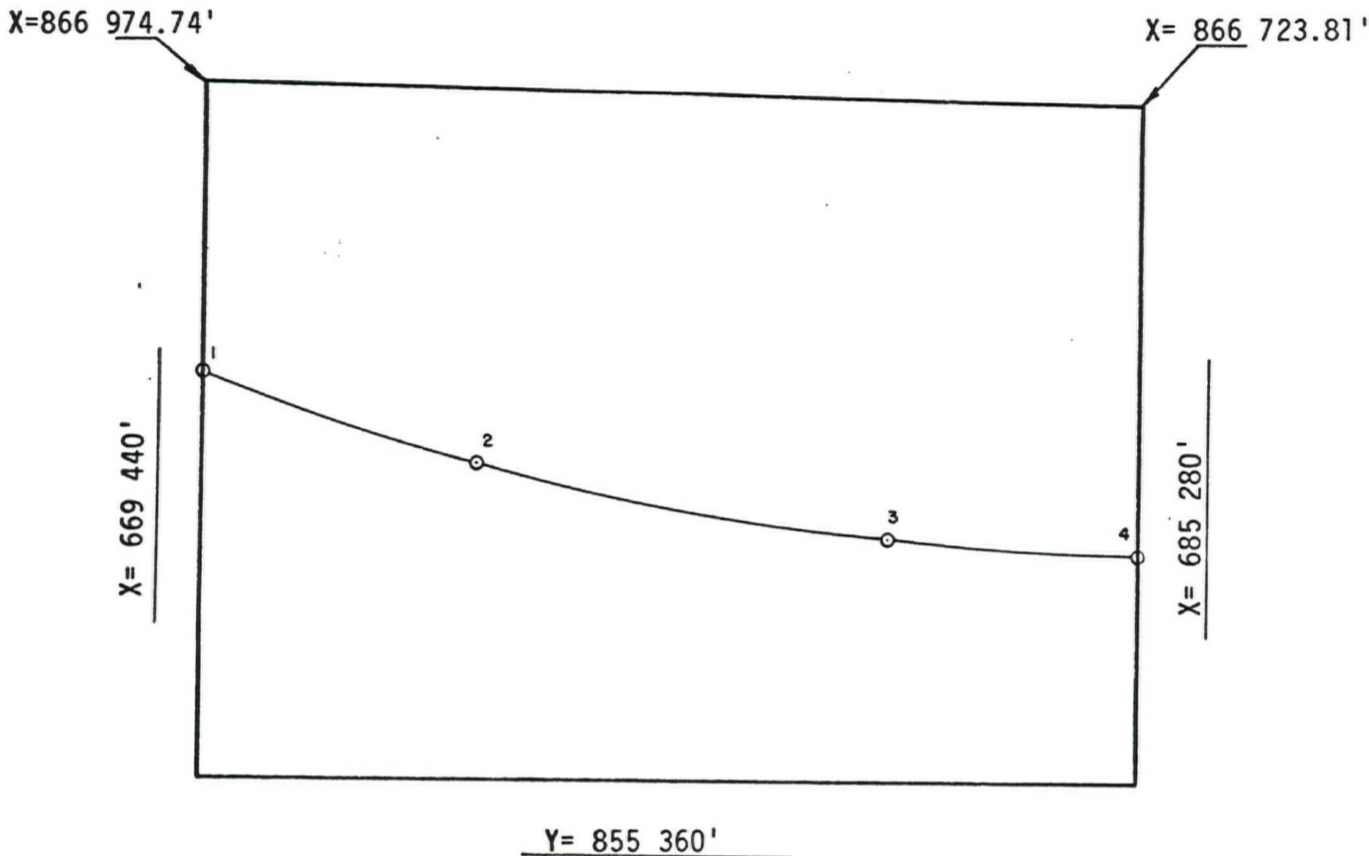

INTERSECTIONS

ARC CENTERS

	X	Y		X	Y
1	<u>669 440.00'</u>	<u>862 179.96'</u>	1-2	<u>683 264.92'</u>	<u>895 913.57'</u>
2	<u>674 066.77'</u>	<u>860 636.39'</u>	2-3	<u>683 885.87'</u>	<u>895 745.80'</u>
3	<u>681 055.98'</u>	<u>859 399.18'</u>	3-4	<u>685 195.26'</u>	<u>895 620.05'</u>
4	<u>685 280.00'</u>	<u>859 163.53'</u>			

This block contains an existing lease. OCS-P 0316

FEDERAL AREA 1741.12 ac STATE AREA _____ BG AREA 2436.81 ac DISPUTED AREA _____
% _____ % _____ % _____ % _____

COMPUTATIONS BY AJD DATE 10/14/83
DRAFTED BY qv DATE 10/19/83
CHECKED BY fv DATE 10/19/83

FOR THE DIRECTOR
Telma J. Hermalin
DATE 10/24/83

FOR THE STATE

DATE _____

UNITED STATES
DEPARTMENT OF THE INTERIOR
BUREAU OF LAND MANAGEMENT

Stipulations for Oil and Gas Lease Sale #48
Outer Continental Shelf
Southern California

TRACT NO. 48-004 BLOCK NO. 55N 84W MAP NO. CAL 6A OCS-P 0316

The area described in Section 2 of this instrument is subject to the following stipulation:

Stipulation No. 1-A

(a) The lessee agrees that prior to operating or causing to be operated on its behalf boat or aircraft traffic into individual, designated warning areas, the lessee shall coordinate and comply with instructions from the Commander, Space and Missile Test Center (SAMTEC) and the Commander, Pacific Missile Test Center (PMTC), or other appropriate military agency. Such coordination and instruction will provide for positive control of boats and aircraft operating into the warning areas at all times.

(b) The lessee, recognizing that mineral exploration and exploitation and recovery operations on the leased areas of submerged lands can impede tactical military operations, hereby recognizes and agrees that the United States reserves and has the right to temporarily suspend operations of the lessee under this lease in the interests of national security requirements. Such temporary suspension of operations, including the evacuation of personnel, and appropriate sheltering of personnel not evacuated (an appropriate shelter shall mean the protection of all lessee personnel for the entire duration of any Department of Defense activity from flying or falling objects or substances), will come into effect upon the order of the Supervisor, after consultation with the Commander, Space and Missile Test Center (SAMTEC) and the Commander, Pacific Missile Test Center (PMTC), or other appropriate military agency, or higher authority, when national security interests necessitate such action. It is understood that any temporary suspension of operations for national security may not exceed seventy-two hours; however, any such suspension may be extended by order of the Supervisor. During such periods equipment may remain in place.

(c) The lessee agrees to control his own electromagnetic emissions and those of his agents, employees, invitees, independent contractors or subcontractors emanating from individual, designated defense warning areas in accordance with requirements specified by the Commander, Space and Missile Test Center (SAMTEC) and the Commander, Pacific Missile Test Center (PMTC), or other appropriate military agency, to the degree necessary to prevent damage to, or unacceptable interference with, Department of Defense flight, testing or operational activities conducted within individual, designated warning areas. Necessary monitoring, control, and coordination with the lessee, his agents, employees, invitees, independent contractors or subcontractors, will be effected by the Commander of the appropriate onshore military installation conducting operations in the particular warning area: Provided, however, that control of such electromagnetic emissions shall permit at least one continuous channel of communication between a lessee, its agents, employees, invitees, independent contractors or subcontractors and onshore facilities.

UNITED STATES
DEPARTMENT OF THE INTERIOR
BUREAU OF LAND MANAGEMENT

Stipulations for Oil and Gas Lease Sale #48
Outer Continental Shelf
Southern California

TRACT NO. 48-004 BLOCK NO. 55N 84W MAP NO. CAL 6A OCS-P 0316

The area described in Section 2 of this instrument is subject to the following stipulation:

Stipulation No. 2

Whether or not compensation for such damage or injury might be due under a theory of strict or absolute liability or otherwise, the lessee assumes all risks of damage or injury to persons or property, which occurs in, on, or above the Outer Continental Shelf, to any person or persons or to any property of any person or persons who are agents, employees or invitees of the lessee, its agents, independent contractors or subcontractors doing business with the lessee in connection with any activities being performed by the lessee in, on, or above the Outer Continental Shelf, if such injury or damage to such person or property occurs by reason of the activities of any agency of the U.S. Government, its contractors, or subcontractors, or any of their officers, agents or employees, being conducted as a part of, or in connection with, the programs and activities of the Space and Missile Test Center (SAMTEC), the Pacific Missile Test Center (PMTC), or other appropriate military agency.

Notwithstanding any limitations of the lessee's liability in section 14 of the lease, the lessee assumes the risk whether such injury or damage is caused in whole or in part by any act or omission, regardless of negligence or fault, of the United States, its contractors or subcontractors, or any of their officers, agents, or employees. The lessee further agrees to indemnify and save harmless the United States against all claims for loss, damage, or injury sustained by the lessee, and to indemnify and save harmless the United States against all claims for loss, damage, or injury sustained by the agents, employees, or invitees of the lessee, its agents or any independent contractors or subcontractors doing business with the lessee in connection with the programs and activities of the aforementioned military installations and agencies, whether the same be caused in whole or in part by the negligence or fault of the United States, its contractors, or subcontractors, or any of their officers, agents, or employees and whether such claims might be sustained under theories of strict or absolute liability or otherwise.

UNITED STATES
DEPARTMENT OF THE INTERIOR
BUREAU OF LAND MANAGEMENT

Stipulations for Oil and Gas Lease Sale #48
Outer Continental Shelf
Southern California

TRACT NO. 48-004 BLOCK NO. 55N 84W MAP NO. CAL 6A OCS-P 0316

The area described in Section 2 of this instrument is subject to the following stipulation:

Stipulation No. 3

If the Supervisor, having reason to believe that a site, structure or object of historical or archaeological significance, hereinafter referred to as a "cultural resource," may exist in the lease area, gives the lessee written notice that the lessor is invoking the provisions of this stipulation, the lessee shall upon receipt of such notice comply with the following requirements:

Prior to any drilling activity or the construction or placement of any structure for exploration or development on the lease, including but not limited to, well drilling and pipeline and platform placement, hereinafter in this stipulation referred to as "operation," the lessee shall conduct remote sensing surveys to determine the potential existence of any cultural resource that may be affected by such operations. All data produced by such remote sensing surveys as well as other pertinent natural and cultural environmental data shall be examined by a qualified marine survey archaeologist to determine if indications are present suggesting the existence of a cultural resource that may be adversely affected by any lease operation. A report of this survey and assessment prepared by the marine survey archaeologist shall be submitted by the lessee to the Supervisor and the Manager, Bureau of Land Management (BLM), Outer Continental Shelf (OCS) Office for review.

If such cultural resource indicators are present the lessee shall (1) locate the site of such operation so as not to adversely affect the identified location; or (2) establish, to the satisfaction of the Supervisor, on the basis of further archaeological investigation conducted by a qualified marine survey archaeologist or underwater archaeologist using such survey equipment and techniques as deemed necessary by the Supervisor, either that such operation shall not adversely affect the location identified or that the potential cultural resource suggested by the occurrence of the indicators does not exist.

A report of this investigation prepared by the marine survey archaeologist or underwater archaeologist shall be submitted to the Supervisor and the Manager, BLM OCS Office for their review. Should the Supervisor determine that the existence of a cultural resource which may be adversely affected by such operation is sufficiently established to warrant protection, the lessee shall take no action that may result in an adverse effect on such cultural resource until the Supervisor has given directions as to its preservation.

The lessee agrees that if any site, structure, or object of historical or archaeological significance should be discovered during the conduct of any operations on the leased area, he shall report immediately such findings to the Supervisor and make every reasonable effort to preserve and protect the cultural resource from damage until the Supervisor has given directions as to its preservation.

UNITED STATES
DEPARTMENT OF THE INTERIOR
BUREAU OF LAND MANAGEMENT

Stipulations for Oil and Gas Lease Sale #48
Outer Continental Shelf
Southern California

TRACT NO. 48-004 BLOCK NO. 55N 84W MAP NO. CAL 6A OCS-P 0316

The area described in Section 2 of this instrument is subject to the following stipulation:

Stipulation No. 4

(a) Wells: Subsea well-heads and temporary abandonments, or suspended operations that leave protrusions above the sea floor, shall be protected, if feasible, by a shroud which will allow commercial trawl gear to pass over the structure without snagging or otherwise damaging the structure or the fishing gear. Latitude and longitude coordinates of these structures along with water depths, shall be submitted to the Supervisor. The coordinates of such structures will be determined by the lessee utilizing state-of-the-art navigation systems with accuracy of at least \pm 50 feet (15.25 meters) at 200 miles (322 kilometers).

(b) Pipelines: All pipelines, unless buried, including gathering lines, shall have a smooth-surface design. In the event that an irregular pipe surface is unavoidable due to the need for valves, anodes or other structures, they shall be protected by shrouds which will allow trawl gear to pass over the object without snagging or otherwise damaging the structure or the fishing gear.

UNITED STATES
DEPARTMENT OF THE INTERIOR
BUREAU OF LAND MANAGEMENT

Stipulations for Oil and Gas Lease Sale #48
Outer Continental Shelf
Southern California

TRACT NO. 48-004 BLOCK NO. 55N 84W MAP NO. CAL 6A OCS-P 0316

The area described in Section 2 of this instrument is subject to the following stipulation:

Stipulation No. 5

(a) If the Supervisor has reason to believe that areas of special biological interest in the lease area contain biological communities or species of such extraordinary or unusual value (even though unquantifiable) that no threat of damage, injury, or other harm to the community or species would be acceptable, he shall give the lessee written notice that the lessor is invoking the provisions of this stipulation and the lessee shall comply with the following requirements: Prior to any drilling activity or the construction or placement of any structure for exploration or development on lease areas including, but not limited to, well drilling and pipeline and platform placement, hereinafter referred to as "operation," the lessee shall conduct site specific surveys as approved by the Supervisor and in accordance with prescribed biological survey requirements to determine the existence of any special biological resource including, but not limited to:

- (1) Very unusual, rare, or uncommon ecosystems or ecotones.
- (2) A species of limited regional distribution that may be adversely affected by any lease operations

If the results of such surveys suggest the existence of a special biological resource that may be adversely affected by any lease operation, the lessee shall: (1) relocate the site of such operation so as not to adversely affect the resources identified; (2) establish to the satisfaction of the Supervisor, on the basis of the site-specific survey, either that such operation will not have a significant adverse effect upon the resource identified or that a special biological resource does not exist. The Supervisor will review all data submitted and determine, in writing, whether a special biological resource exists or may be significantly affected by lessee's operations. The lessee may take no action until the Supervisor has given the lessee written directions on how to proceed.

(b) The lessee agrees that if any area of biological significance should be discovered during the conduct of any operations on the leased area, he shall report immediately such findings to the Supervisor, and make every reasonable effort to preserve and protect the biological resource from damage until the Supervisor has given the lessee directions with respect to its protection.

UNITED STATES
DEPARTMENT OF THE INTERIOR
BUREAU OF LAND MANAGEMENT

Stipulations for Oil and Gas Lease Sale #48
Outer Continental Shelf
Southern California

TRACT NO. 48-004 BLOCK NO. 55N 84W MAP NO. CAL 6A OCS-P 0316

The area described in Section 2 of this instrument is subject to the following stipulation:

Stipulation No. 6

(a) Pipelines will be required, (1) if pipeline rights-of-way can be determined and obtained, (2) if laying of such pipelines is technologically feasible and environmentally preferable, and (3) if, in the opinion of the lessor, pipelines can be laid without net social loss, taking into account any incremental costs of pipelines over alternative methods of transportation and any incremental benefits in the form of increased environmental protection or reduced multiple use conflicts. The lessor specifically reserves the right to require that any pipeline used for transporting production to shore be placed in certain designated management areas. In selecting the means of transportation, consideration will be given to any recommendation of the intergovernmental planning program for leasing and management of transportation of Outer Continental Shelf oil and gas with the participation of Federal, State, and local government and the industry. Where feasible, and environmentally preferable, all pipelines, including both flow lines and gathering lines for oil and gas, shall be buried to a depth suitable for adequate protection from water currents, sand waves, storm scouring, fisheries' trawling gear, and other uses as determined on a case-by-case basis.

(b) Following the completion of pipeline installation, no crude oil production will be transported by surface vessel from offshore production sites, except in the case of emergency. Determinations as to emergency conditions and appropriate responses to these conditions will be made by the Supervisor. Where the three criteria set forth in the first sentence of this stipulation are not met and surface transportation must be employed, all vessels used for carrying hydrocarbons to shore from the leased area will conform with all standards established for such vessels, pursuant to the Ports and Waterways Safety Act of 1972 (46 U.S.C., 391a), as amended.

CHAMPLIN PETROLEUM COMPANY

(Lessee)

BY: D O Churchill
(Signature of Authorized Officer)

D. O. Churchill
(Name of Signatory)

Vice-President
(Title)

August 14, 1979
(Date)

P.O. Box 1257
Englewood, CO 80150
(Address of Lessee)

ATTEST:

R M Moss
R. M. MOSS Assistant Secretary

PHILLIPS PETROLEUM COMPANY
(Lessee)

ATTEST:

BY:
(Signature of Authorized Officer)

Harvey W. Thompson
HARVEY W. THOMPSON Secretary

L. M. Rickards
L. M. Rickards
(Name of Signatory)

Vice President
(Title)

August 10, 1979
(Date)

7800 E. Dorado Place
Englewood, CO 80111
(Address of Lessee)

ICI DELAWARE INC.
(Lessee)

By Michael E. Elling
(Signature of Authorized Officer)

MICHAEL E. ELLING
(Name of Signatory)

Assistant Secretary
(Title)

August 15, 1979
(Date)

Wilmington, DE 19897
(Address of Lessee)