

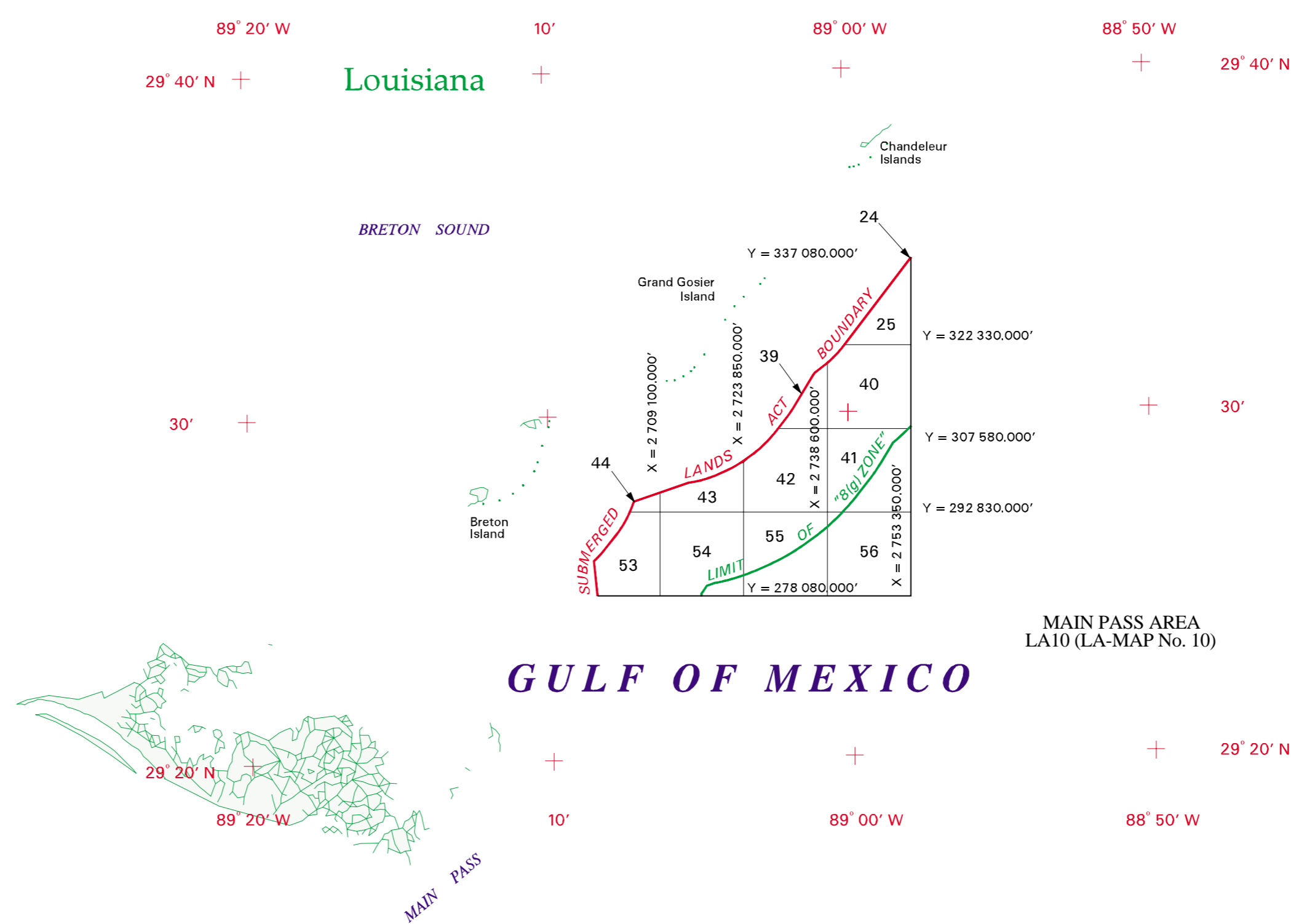

**LOUISIANA
GULF COAST INDEX**

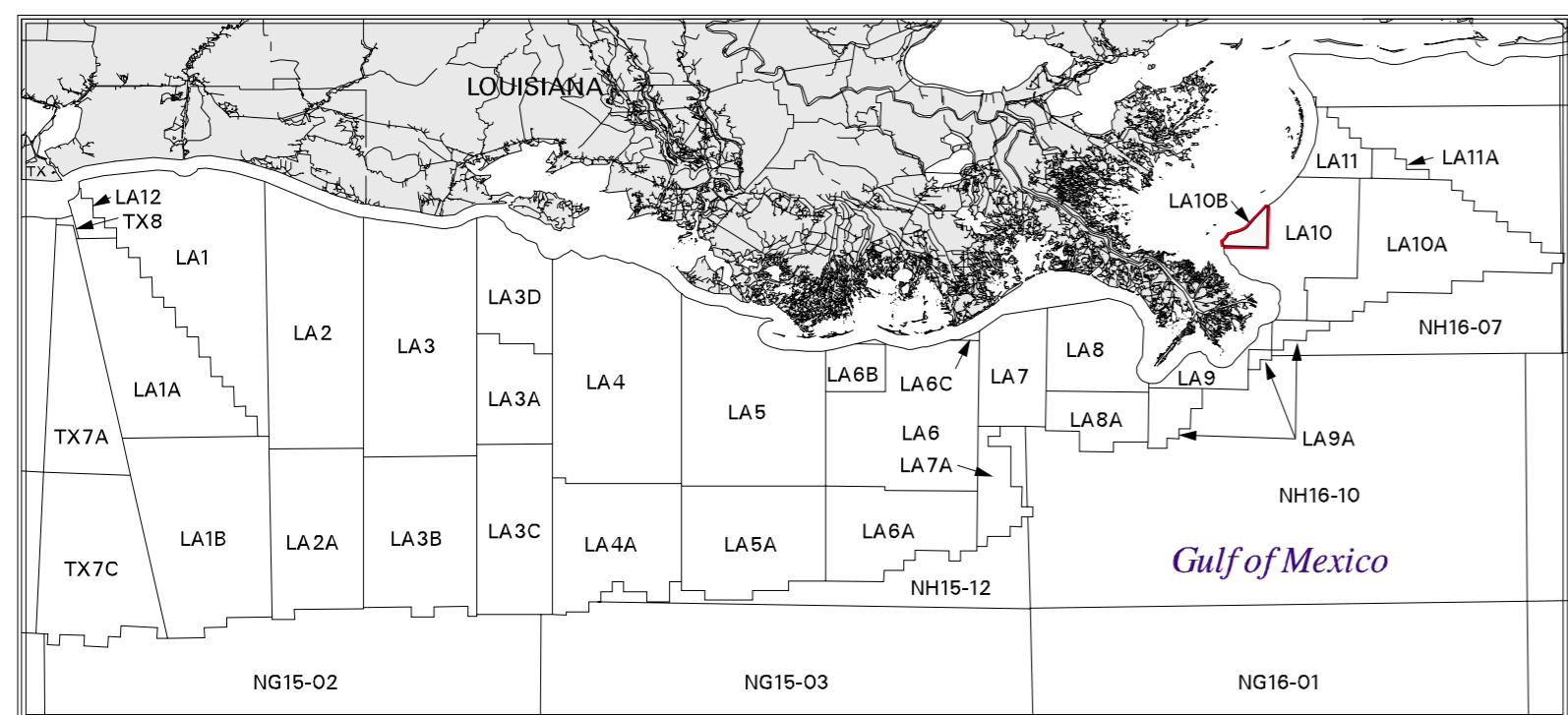

MAIN PASS AREA
LA10 (LA-MAP No. 10)

All blocks are based on the Louisiana (Lambert) Plane Coordinate System, South Zone, with X origin = 2,000,000' at 91° 20' W and Y origin = 0.00' at 28° 40' N.

Onshore planimetric base compilation is from U.S.G.S. 1:100 000 Digital Line Graph (DLG) Files.

The Submerged Lands Act Boundary and Limit of "8(g) Zone" lines depicted hereon reflect the official federal position for Submerged Lands Act and OCS Lands Act purposes. The areas of the fractional blocks abutting these lines have been determined and are as depicted on the Supplemental Official OCS Block Diagrams (SOBD's). Consult the SOBD's for official descriptions and approval dates.

This revised map supersedes leasing map BRETON SOUND AREA, LA-MAP No. 10B, approved 01-JUN-1988, and LA10B revised 01-SEP-1999.

LA10B was created by removing the BRETON SOUND AREA from map LA10, MAIN PASS AND BRETON SOUND AREAS, dated 08-JUN-1954 and revised 22-JUL-1954.

Copies of these diagrams and other information may be obtained at the appropriate MMS OCS Region.

UNITED STATES DEPARTMENT OF THE INTERIOR
MINERALS MANAGEMENT SERVICE

**OUTER CONTINENTAL SHELF LEASING MAP
LOUISIANA**

NORTH AMERICAN DATUM OF 1927

Scale 1:250 000

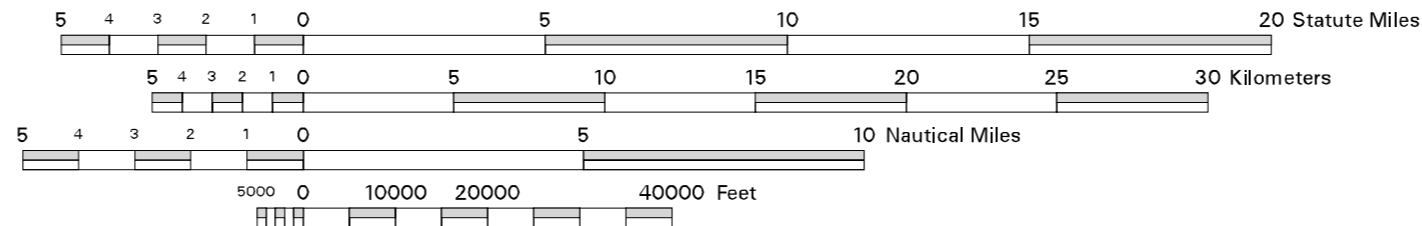

**Subdivision of Blocks
on the
Outer Continental Shelf**

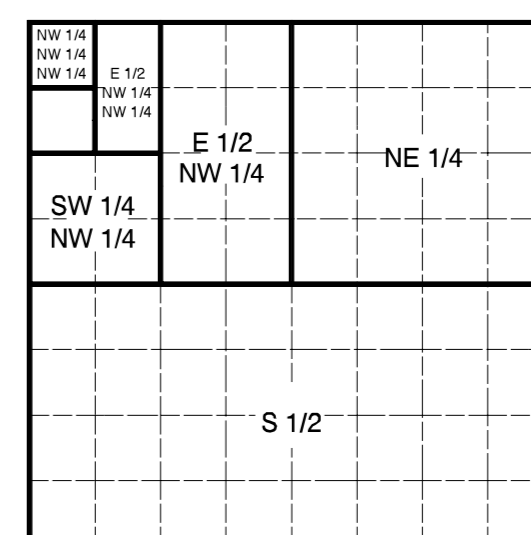

Typical method of subdivision of the regular blocks, each subdivision being an aliquot part of the total, based on midpoint subdivision throughout.

This diagram is prepared in accordance with 30 CFR 256.8

For the Director

Selma E. Hummel

Chief, Leasing Division, Mapping and Boundary Branch
Denver, Colorado Date 01-NOV-2000

Revised