

DISC PAK NO.

FILE NO.

UNITED STATES DEPARTMENT OF INTERIOR
BUREAU OF LAND MANAGEMENT

SUPPLEMENTAL OFFICIAL
OCS BLOCK DIAGRAM
8-G BLOCK

OPD NO. NO 5-1

BLOCK NO. 703

OCS LEASE NO. _____

STATE LEASE NO. _____

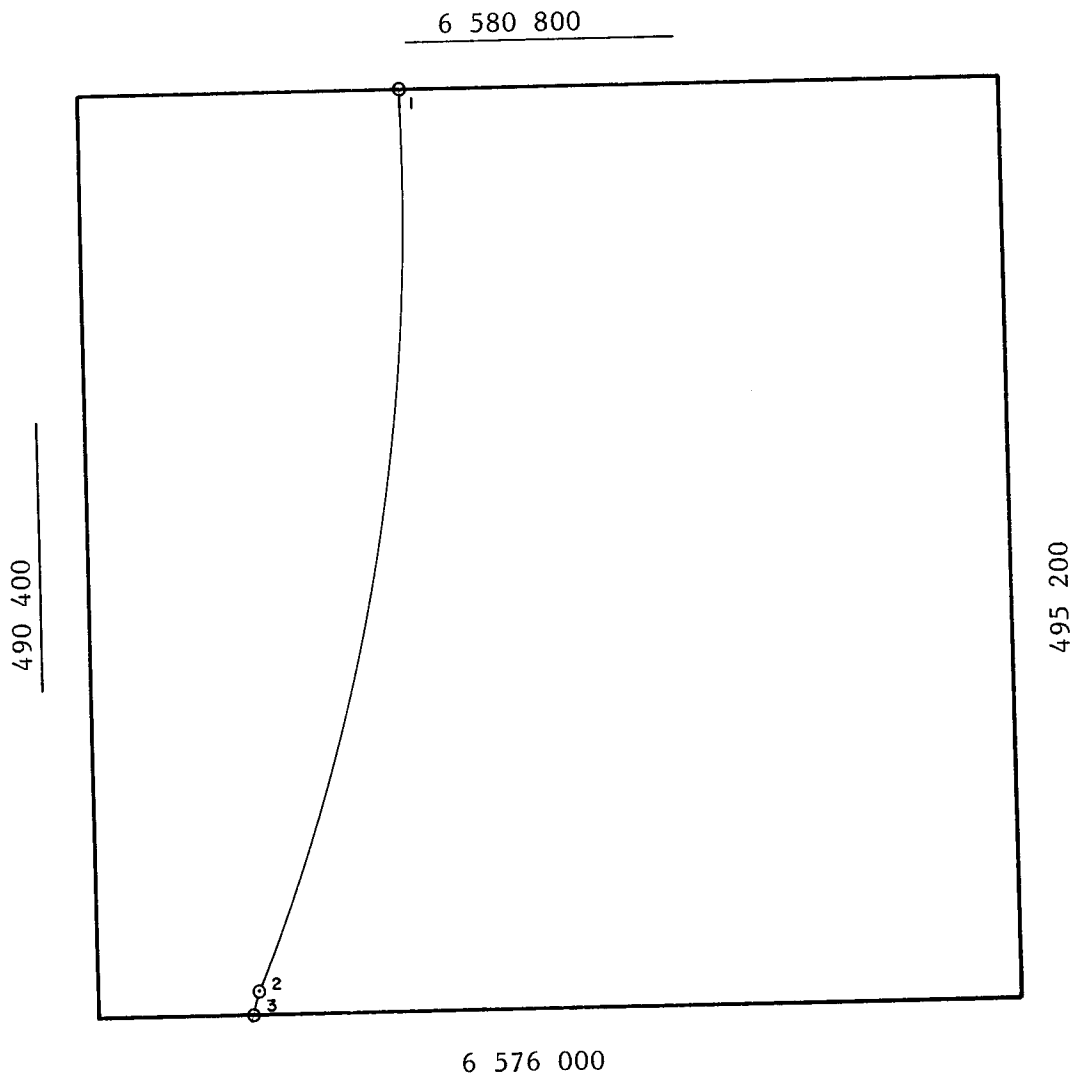

INTERSECTIONS

| | X | Y |
|---|------------|--------------|
| 1 | 492 062.42 | 6 580 800.00 |
| 2 | 491 214.02 | 6 576 080.24 |
| 3 | 491 185.55 | 6 576 000.00 |
| | | |
| | | |
| | | |
| | | |
| | | |
| | | |
| | | |
| | | |

ARC CENTERS

| | X | Y |
|-----|------------|--------------|
| 1-2 | 480 959.15 | 6 580 359.75 |
| 2-3 | 480 727.10 | 6 579 754.62 |
| | | |
| | | |
| | | |
| | | |
| | | |
| | | |
| | | |
| | | |

FEDERAL AREA 1629.29 ha

% _____

STATE AREA _____

% _____

8-G AREA 674.71 ha

% _____

COMPUTATIONS BY RAK DATE 8/12/81

DRAFTED BY H DATE 08/26/81

CHECKED BY LBK DATE 8/27/81

FOR THE DIRECTOR

Harry L. Spright

DATE 8/27/81

FOR THE STATE

Joseph C. Bunt

DATE 9/4/81